



# INSTALLATION GUIDE

## REAR STORAGE BOX ADAPTER BRACKETS (FOR OWL B2)

UN1111B



### TOOLS REQUIRED (NOT INCLUDED)

- + 9/16" WRENCH OR SOCKET
- + 7/32" ALLEN WRENCH
- + MEASURING TAPE

### INSTALL INFO

TIME TO INSTALL THIS PRODUCT: 30-45 MINUTES

Additional help is suggested for a few of the install steps.

### BEFORE YOU START

Please inspect the product and packaging upon delivery to ensure there are no issues and that all parts and hardware are accounted for.

Contact us ASAP if anything is missing at:  
[support@flatlinevanco.com](mailto:support@flatlinevanco.com)

# BEFORE YOU START

All Flatline Van Co products must be properly assembled and secured before attaching to your vehicle. Improper attachment could result in an automobile accident, and could cause serious bodily injury or death to you or to others involved. You are responsible for assembling and securing Flatline Van Co products to your vehicle, checking the mounting points and attachments prior to use, and regularly inspecting the products for wear and or damage. We always recommend you use a professional to install any aftermarket accessories to your vehicle. If you have no mechanical experience and are not thoroughly familiar with the installation procedures, you must have the product installed by a professional installer or other qualified persons. The responsibility is yours and must be taken seriously for everyone's safety.



# PACKAGE CONTENTS

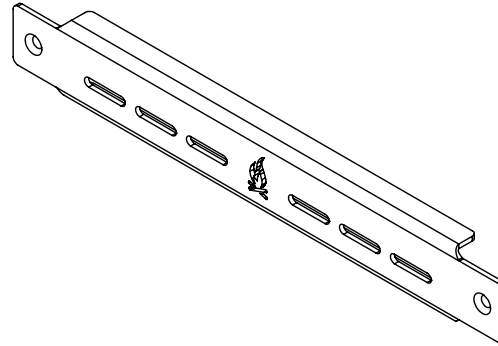

BOX ADAPTER BRACKETS

QTY: 2

# HARDWARE

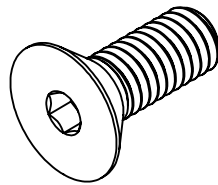

3/8-16 X 1 FLAT HEAD HEX DRIVE  
SCREW

QTY: 4



3/8 SCREW FLAT WASHER

QTY: 4

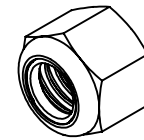

3/8-16 NYLON LOCKNUT

QTY: 4

# INSTALL

TOOLS REQUIRED FOR THIS STEP: + MEASURING TAPE

## STEP | 01 LAYOUT AND INSTALL PREP

**1.1 Rear Storage Box Mounting Holes:** Note the relevant dimensions for the spacing between mounting holes for your style of **Storage Box**. **FIG 1** depicts the spacing for our **Rear Storage Box** and **FIG 2** for our **Ski Storage Box**.

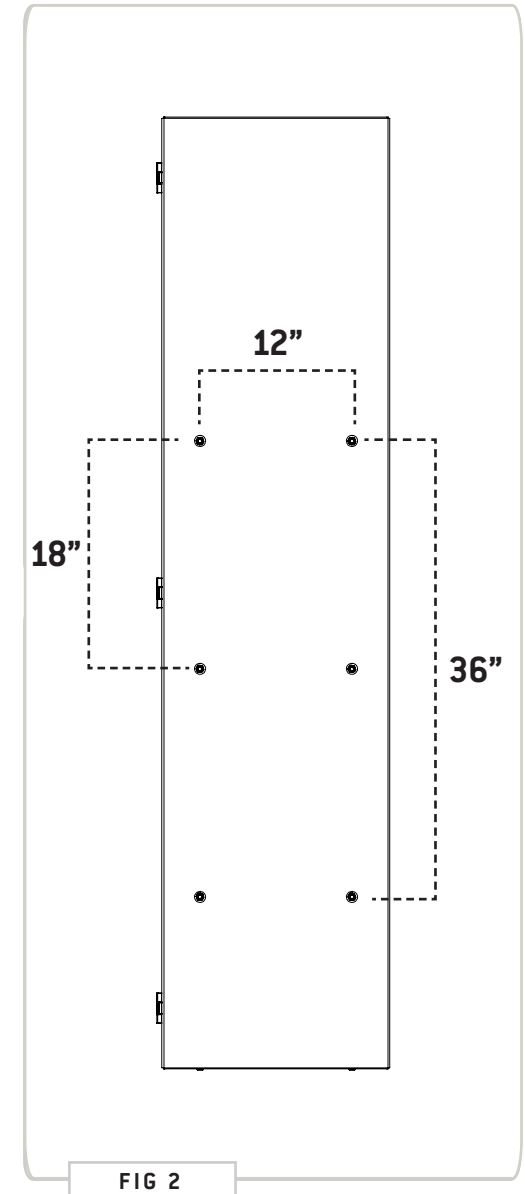
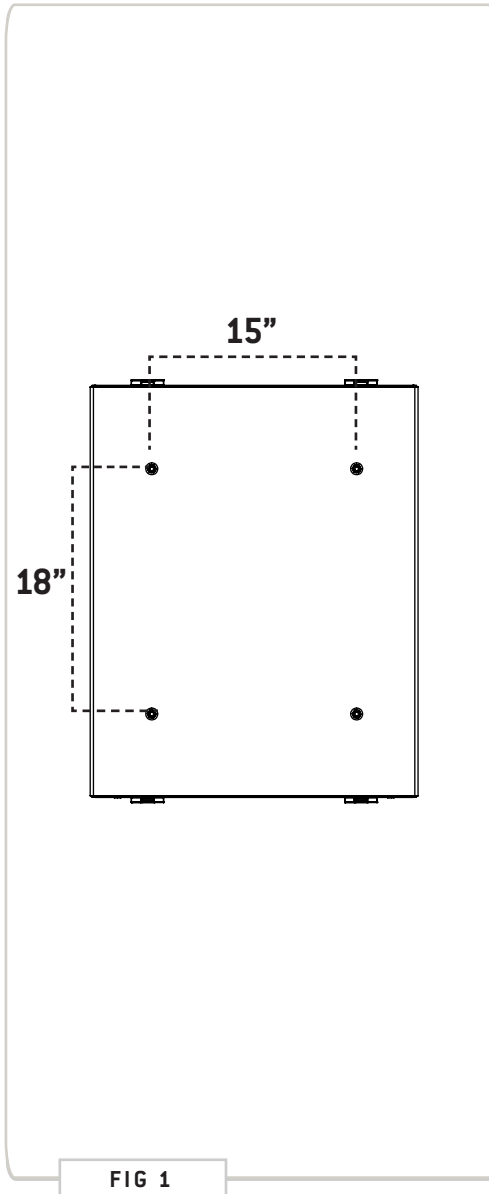

TOOLS REQUIRED FOR THIS STEP:

## STEP | 01 LAYOUT AND INSTALL PREP

**1.2 Choose Mounting Height:** Dry fit your **Storage Box** to your **B2 Carrier** and choose a mounting height that best suits your needs (**FIG 3**). Determine what mounting holes along the **B2 Carrier** line up with those of the **Storage Box (FIG 3)** and take note for positioning the **Adapter Brackets** in the next step.

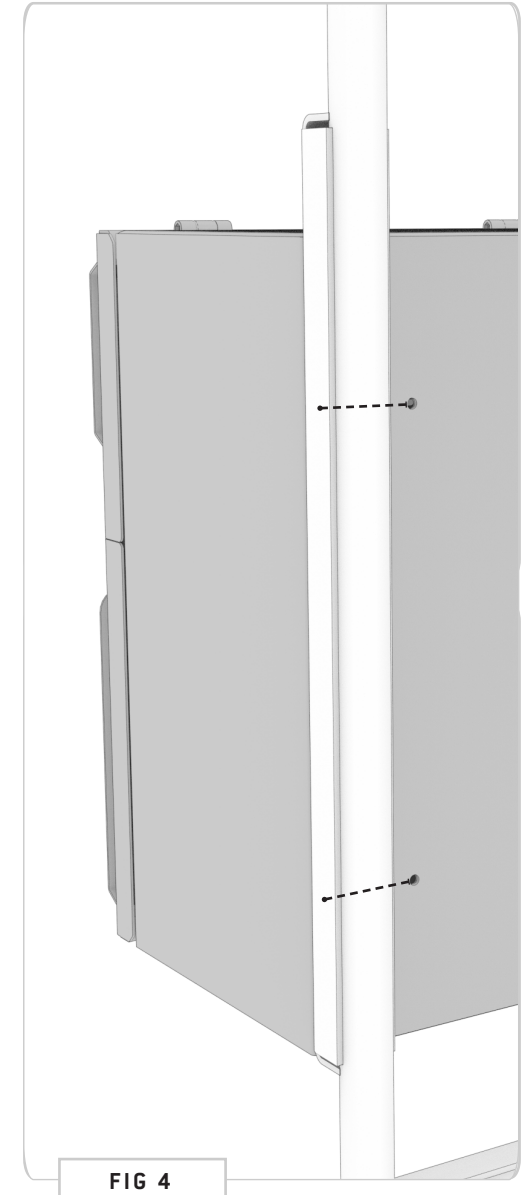

## STEP | 02 INSTALL ADAPTER BRACKETS

**2.1 Install Adapter Brackets:** Install the **Adapter Brackets** in your desired location using **(2ea) 3/8" Flat Head Hex Drive Screws, Flat Washers and Nylon Locknuts** as shown in **FIG 5**.

**TOOLS REQUIRED FOR THIS STEP:** + 7/32" ALLEN WRENCH  
+ 9/16" WRENCH OR SOCKET

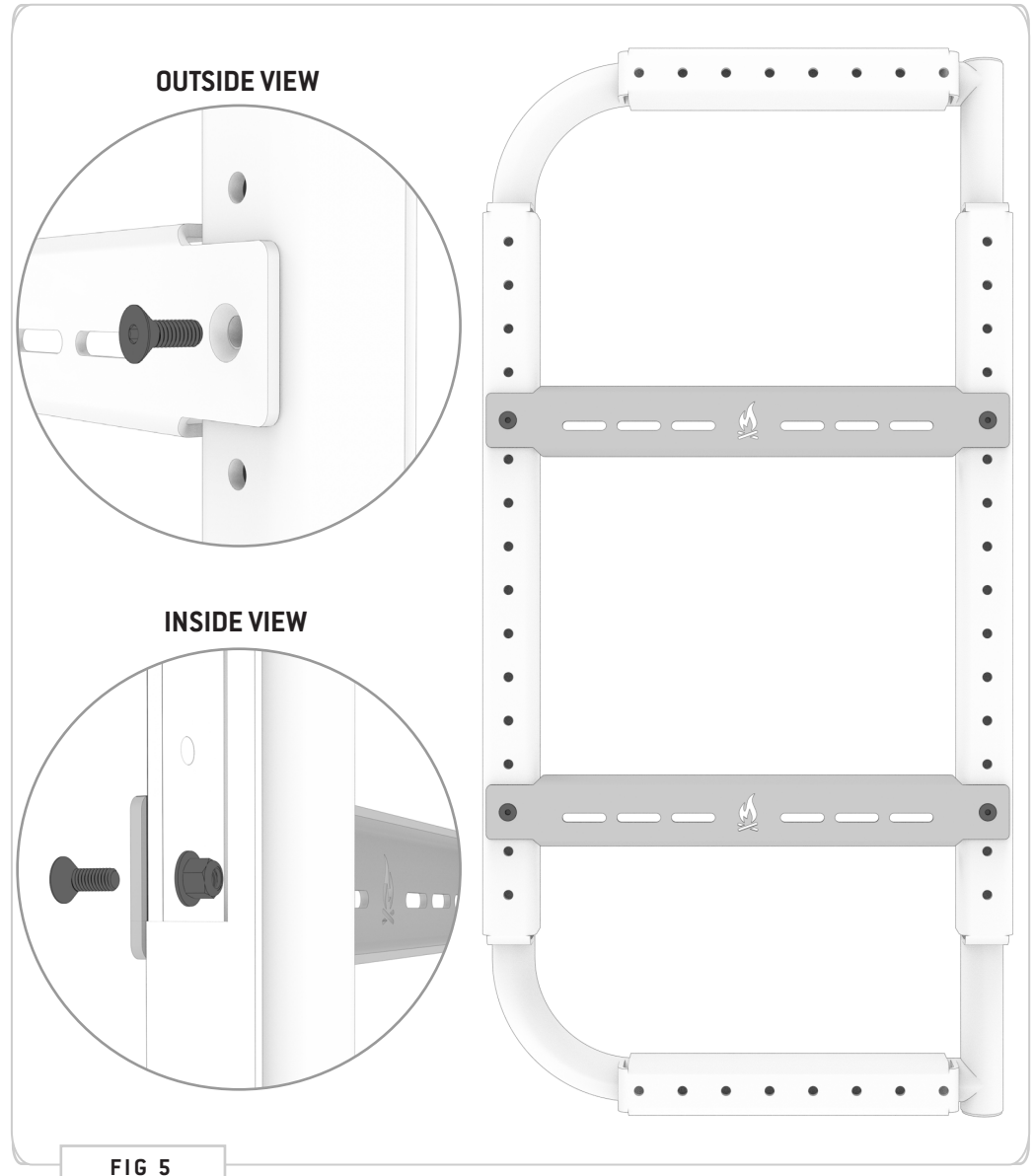

TOOLS REQUIRED FOR THIS STEP: + 9/16" WRENCH OR SOCKET

## STEP | 03 INSTALL STORAGE BOX

**3.1 Loosely Attach Storage Box:** Loosely install the **Storage Box** to the **Adapter Brackets** (and **B2 Carrier** if applicable) using the hardware provided with the **Storage Box (FIG 6)**.

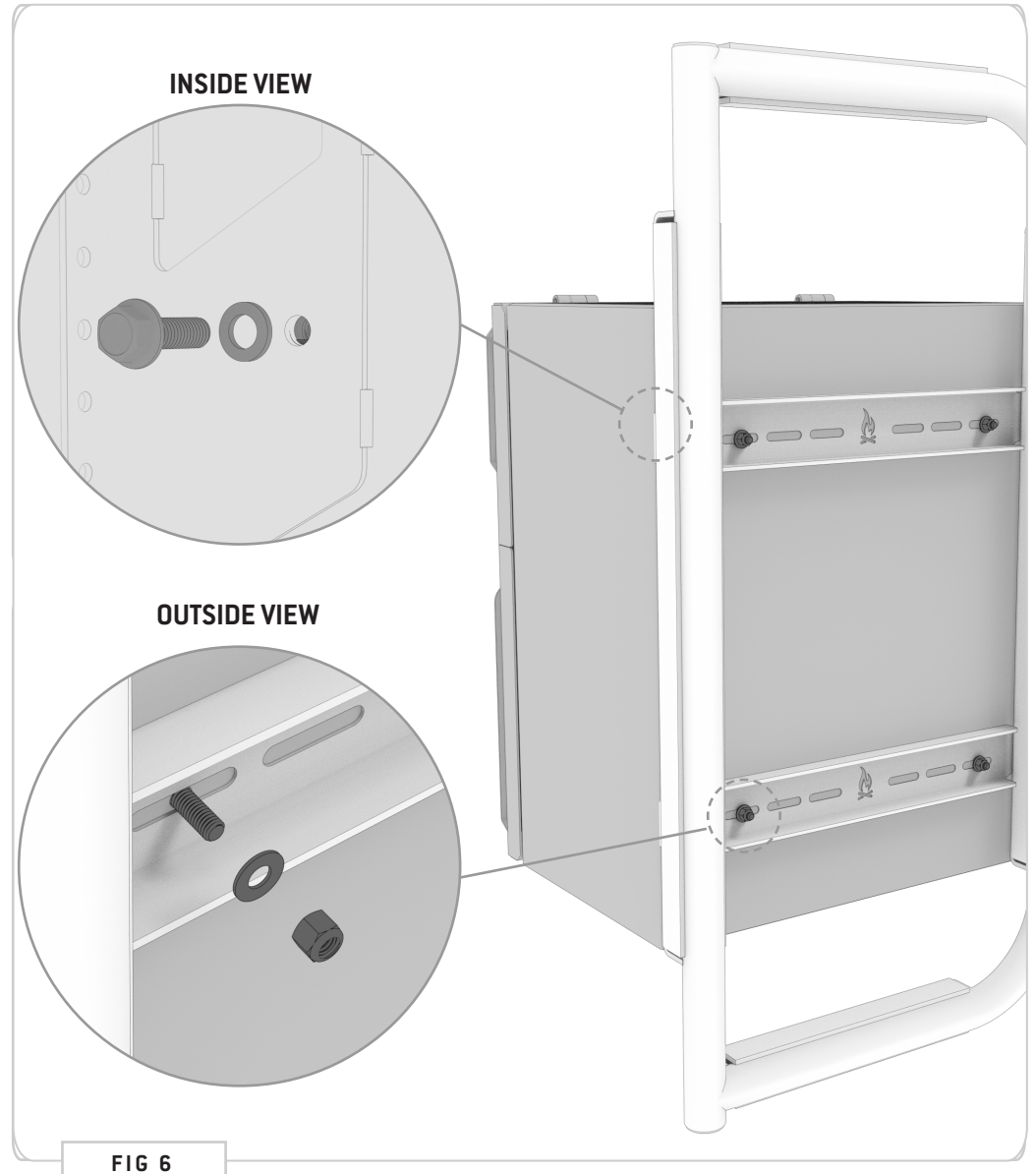

FIG 6



## STEP | 03 INSTALL STORAGE BOX

**3.2 Adjust Left-to-Right Alignment:** There are pill slots with built-in adjustment in the **Adapter Brackets** for Left-to-Right Alignment. Align to your desired location.

TOOLS REQUIRED FOR THIS STEP:

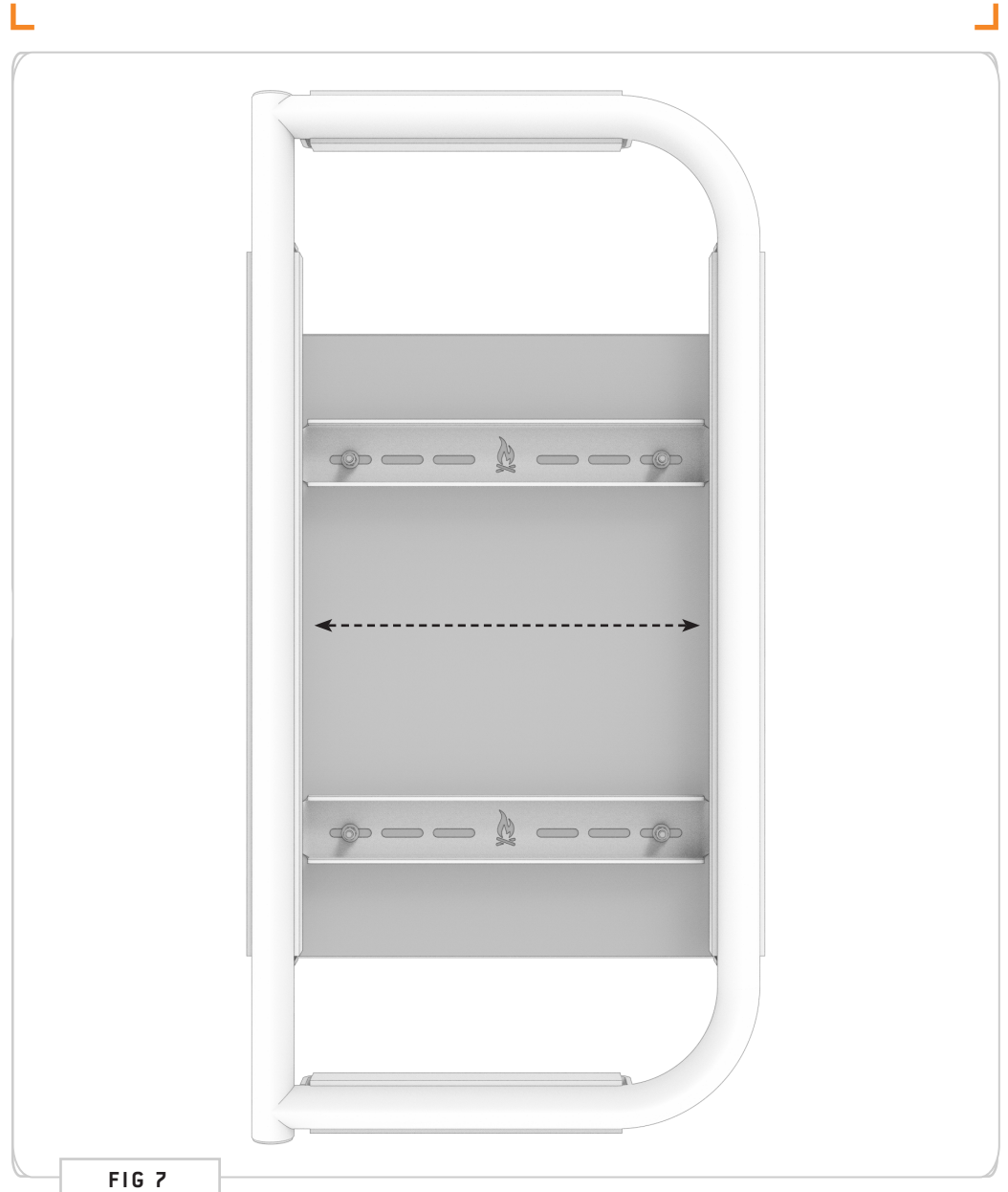

TOOLS REQUIRED FOR THIS STEP: + 9/16" WRENCH OR SOCKET

### STEP | 03 INSTALL STORAGE BOX

**3.3 Tighten All Fasteners:** Once you are satisfied with the placement of the **Storage Box** on your **B2 Carrier**, tighten all fasteners to secure it in place (**FIG 8**).



FIG 8

# GET OUT AND EXPLORE!

## + LEAVE US A REVIEW

---

Happy with your new FVC product? We would love to hear (and see) from you! Head to the product page and click "Leave Review." Add a short review and upload a few photos to be showcased on the product page.

## + SHARE YOUR PICS

---

We love seeing how our customers use their FVC products and following along with your adventures. Tag us in your photos with: @flatlinevanco or send them to us via email. We love posting customer pictures in our feed!

## + NEED ANY HELP?

---

If you are having any issues with your product, please reach out, and we will make it right. FVC is a company of van and outdoor enthusiasts that design and use our own products, so we want you to be as stoked on your new parts as we are!



@FLATLINEVANCO