



INSTALLATION GUIDE

UNIVERSAL WHEEL WELL BOX

UN1009B



TOOLS REQUIRED (NOT INCLUDED)

- | | |
|--------------------------|------------------------|
| + 7/16" WRENCH OR SOCKET | + 13MM WRENCH |
| + 4MM ALLEN WRENCH | + POWER DRILL |
| + 10MM WRENCH OR SOCKET | + 5/64" DRILL BIT |
| + 12MM WRENCH | + PHILLIPS SCREWDRIVER |

INSTALL INFO

TIME TO INSTALL THIS PRODUCT: 30-45 MINUTES

Additional help is suggested for a few of the install steps.

BEFORE YOU START

Please inspect the product and packaging upon delivery to ensure there are no issues and that all parts and hardware are accounted for.

Contact us ASAP if anything is missing at:
support@flatlinevanco.com

BEFORE YOU START

All Flatline Van Co products must be properly assembled and secured before attaching to your vehicle. Improper attachment could result in an automobile accident, and could cause serious bodily injury or death to you or to others involved. You are responsible for assembling and securing Flatline Van Co products to your vehicle, checking the mounting points and attachments prior to use, and regularly inspecting the products for wear and or damage. We always recommend you use a professional to install any aftermarket accessories to your vehicle. If you have no mechanical experience and are not thoroughly familiar with the installation procedures, you must have the product installed by a professional installer or other qualified persons. The responsibility is yours and must be taken seriously for everyone's safety.



PACKAGE CONTENTS

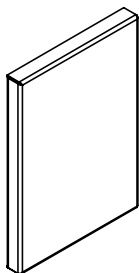

RIGHT SIDE PANEL

QTY: 1

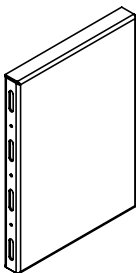

LEFT SIDE PANEL

QTY: 1

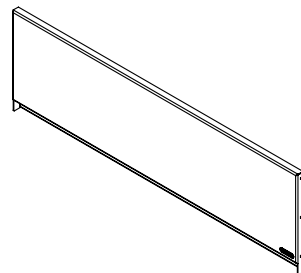

FRONT PANEL ASSEMBLY

QTY: 1

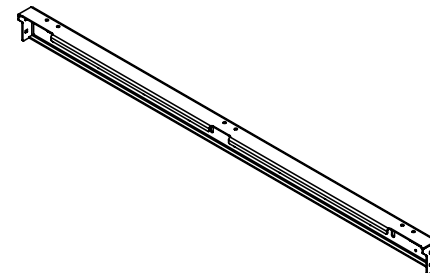

REAR STRETCHER

QTY: 1

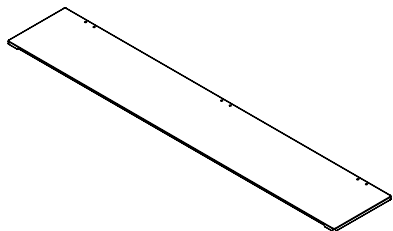

BOX TOP

QTY: 1

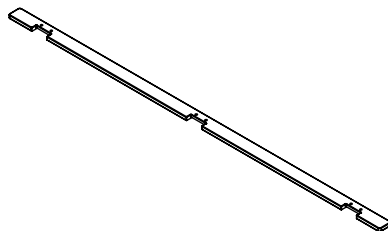

STRETCHER TOP PANEL

QTY: 1

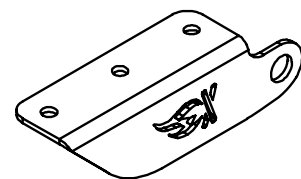

RIGHT SIDE STRUT BRACKET

QTY: 1

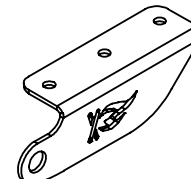

LEFT SIDE STRUT BRACKET

QTY: 1

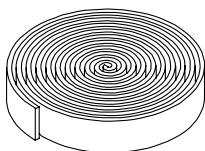

TOP GASKET

QTY: 1

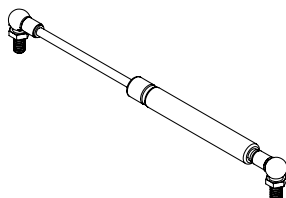

GAS STRUTS

QTY: 2

IF PURCHASED SEPARATELY:

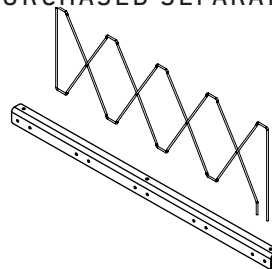

BUNGEE BRACKETS + BUNGEE

QTY: 2

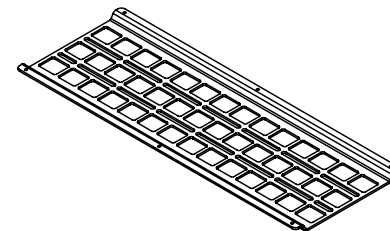

MOLLE PANEL

QTY: 1

HARDWARE

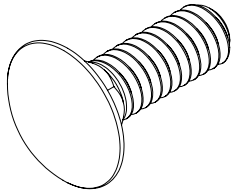

1/4-20 X 0.75 SQUARE NECK
CARRIAGE BOLT

QTY: 10

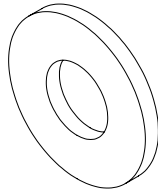

1/4 SCREW FLAT WASHER

QTY: 10

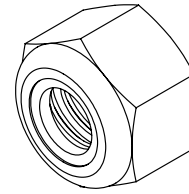

1/4-20 NYLON INSERT
LOCKNUT

QTY: 10

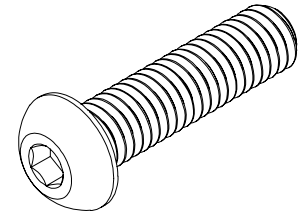

M6-1 X 25 BUTTON HEAD
HEX DRIVE SCREW

QTY: 12

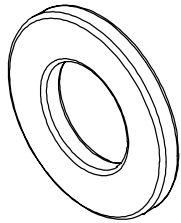

M8 FLAT WASHER

QTY: 4

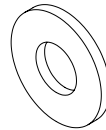

M6 FLAT WASHER

QTY: 12

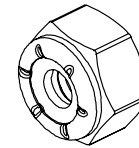

M6-1 NYLON INSERT LOCKNUT

QTY: 12

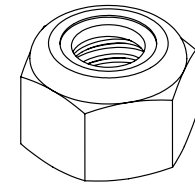

M8-1.25 NYLON INSERT
LOCKNUT

QTY: 4

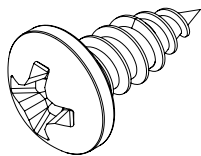

#6 X 0.375 ROUND HEAD
PHILLIPS DRIVE SCREW

QTY: 6

WITH BUNGEE:

QTY: +6

WITH MOLLE:

QTY: +6

INSTALL

STEP | 01 LAYOUT AND INSTALL PREP

Determining where you'd like to install your **Wheel Well Box** is up to you, however there are some tips that make choosing the location a little easier.

Take the time to measure your available wall space and layout potential locations before installing. Relevant dimensions are shown in **FIG 1**.

NOTE - The unit is designed to span the **Wheel Wells**, but can be mounted anywhere you'd like.

TOOLS REQUIRED FOR THIS STEP:

TOP VIEW

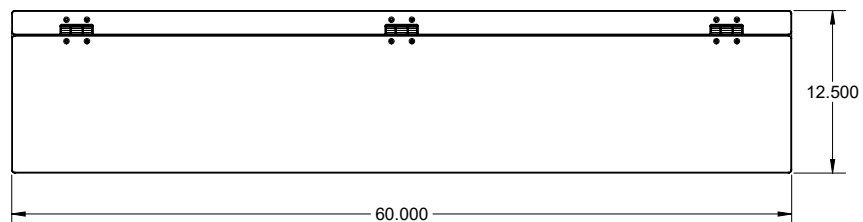

FRONT VIEW

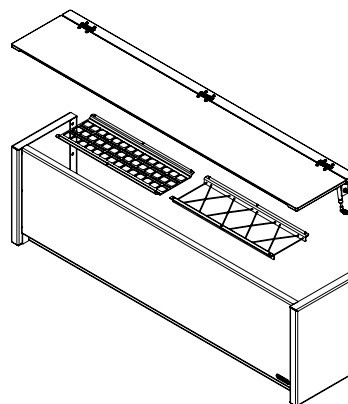
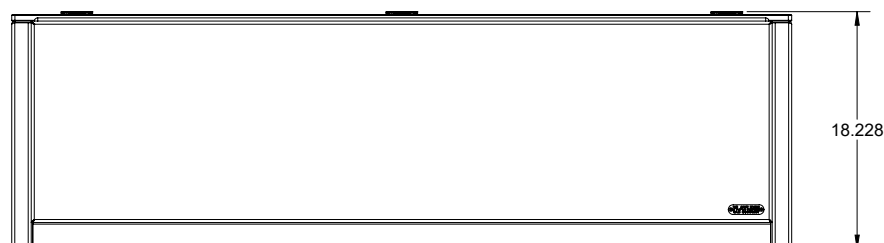

SIDE VIEW

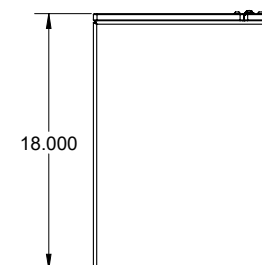

FIG 1

TOOLS REQUIRED FOR THIS STEP:

STEP | 02 WHEEL WELL BOX ASSEMBLY

2.1 Organize and Layout Parts: Position the **Front Panel** face-down on a flat, non-abrasive surface (**FIG 3**).

2.2 Determine Wheel Well Box Depth: You might install the **Front Panel** to the **Side Panels** in a *recessed* (**FIG 4**) or *flush* (**FIG 5**) style.



FIG 3



FIG 4



FIG 5

TOOLS REQUIRED FOR THIS STEP: + 7/16" WRENCH OR SOCKET

STEP | 02 WHEEL WELL BOX ASSEMBLY

2.3 Align The Right Side Panel To Front Panel: There are two sets of mounting holes along the interior of the **Side Panels** that you can use to either install the **Front Panel** in the *Flush* or *Recessed* positions.

2.4 Assemble Panels: Insert 1/4-20 X 0.75 Square Neck Carriage Bolts through aligned holes (FIG 6), adding Flat Washers and Locknuts on the inside (FIG 7). Hand-tighten. Repeat steps for the **Left Side Panel**.

2.5 Secure Panels: Square up the assembly and fully tighten all hardware (FIG 8).



FIG 6

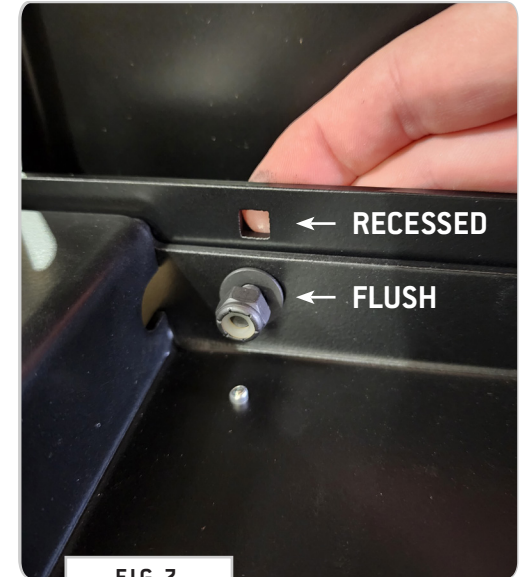

FIG 7



FIG 8

TOOLS REQUIRED FOR THIS STEP: + 7/16" WRENCH OR SOCKET

STEP | 02 WHEEL WELL BOX ASSEMBLY

2.6 Position Rear Stretcher: Place the **Rear Stretcher** between the **Left and Right Side Panels** in the orientation shown in FIG 9-11.

2.7 Secure Assembly: Insert **1/4-20 X 0.75 Square Neck Carriage Bolts** through aligned holes (FIG 10), adding **Flat Washers** and **Locknuts** on the inside (FIG 11). Tighten up fasteners.



FIG 9



FIG 10



FIG 11

STEP | 03 BAMBOO BOX LID ASSEMBLY

3.1 Position Stretcher Panel: Set the **Top Stretcher Panel** across the **Rear Stretcher** of the **Wheel Box Assembly** (FIG 12).

3.2 Position Torque Hinges: Slide the mounting plate of the **Torque Hinges** beneath the cutouts in the **Top Stretcher Panel** and align the mounting holes. (FIG 13)

3.3 Secure Torque Hinges to Top Stretcher Panel: Using (2ea) **M6 Button Head Screws**, **Flat Washers** and **Nylon Locknuts**, secure **Hinge Mounting Plate** (FIG 14).

TOOLS REQUIRED FOR THIS STEP: + 4MM ALLEN WRENCH
+ 10MM WRENCH OR SOCKET



FIG 12



FIG 13



FIG 14

STEP | 03 BAMBOO BOX LID ASSEMBLY

3.4 Position Bamboo Top: Set the **Bamboo Top** across the top of the **Wheel Box Assembly** (FIG 15).

3.5 Position Torque Hinges: Slide the **Bamboo Top** over the mounting plate of the **Torque Hinges** and align the mounting holes (FIG 16).

3.6 Secure Torque Hinges to Bamboo Top: Using (2ea) **M6 Button Head Screws**, **Flat Washers** and **Nylon Locknuts**, secure **Hinge Mounting Plate** (FIG 17+18).

TOOLS REQUIRED FOR THIS STEP: + 4MM ALLEN WRENCH
+ 10MM WRENCH OR SOCKET



FIG 15

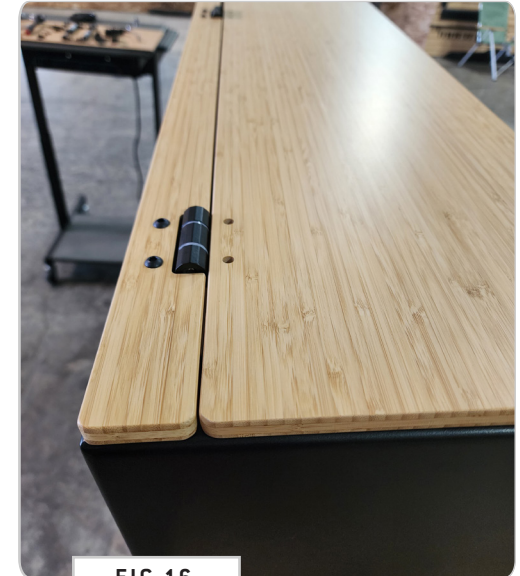

FIG 16

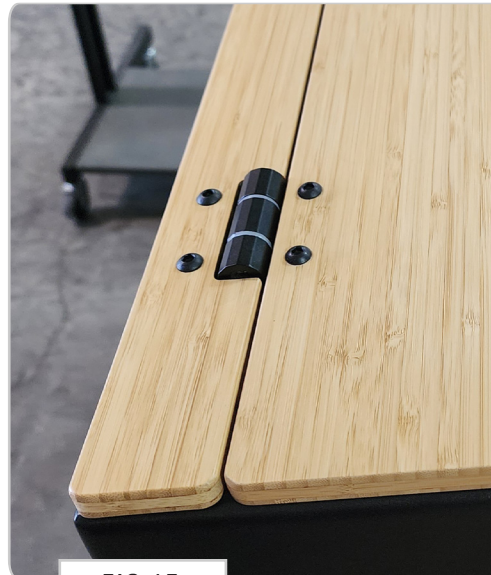

FIG 17



FIG 18

TOOLS REQUIRED FOR THIS STEP: + PHILLIPS SCREWDRIVER

STEP | 03 BAMBOO BOX LID ASSEMBLY

3.7 Attach Left and Right Strut Brackets to Bamboo Top: Inside the assembly, near the hinge points, there are pre-drilled holes that you can attach the **Left and Right Strut Brackets (FIG 15)** to. Secure them in the orientations shown using **(3ea) #6 X 0.375 Round Head Phillips Drive Screws (FIG 20+21)**.



FIG 19



FIG 20



FIG 21

TOOLS REQUIRED FOR THIS STEP: + 12MM WRENCH
+ 13MM WRENCH

STEP | 03 BAMBOO BOX LID ASSEMBLY

3.8 Install Gas Struts: Install **Gas Struts** rod side down to the **Left and Right Side Panels (FIG 22)** using **M8 Washers** and **Nylon Locknuts (FIG 23)**. Repeat for **Left and Right Strut Brackets (FIG 25)**.

3.9 Confirm Fitment: Verify that the lid is supported well and opens with spring assist.



FIG 22



FIG 23



FIG 24



FIG 25

TOOLS REQUIRED FOR THIS STEP: + SCISSORS

STEP | 04 FINISHING TOUCHES

4.1 Attach Foam Gasket: To prevent rattling, attach **Foam Gasket (FIG 26)** material to the upper flanges of the **Left, Right and Front Panels**. Layout the **Gasket** and trim to fit (**FIG 27**).



FIG 26



FIG 27

STEP | 05 INSTALL MOLLE PANEL(S)

5.1 Attach Molle Panel (optional): If you purchased **Molle Panels** for your **Wheel Well Box**, attach them to the pre-drilled holes along the inside of the **Bamboo Top** using (6) #6 X 0.375 Round Head Phillips Drive Screws (FIG 28).

NOTE - If the pre-drilled holes don't align with those of the **Molle Panel** (FIG 29), drill out new holes using a 5/64" or similar sized bit (FIG 30). Make sure you only drill them out enough to thread in the screws and not all the way through the **Bamboo Top**.

TOOLS REQUIRED FOR THIS STEP: + PHILLIPS SCREWDRIVER
+ POWER DRILL
+ 5/64" DRILL BIT



FIG 28



FIG 29



FIG 30

STEP | 06 INSTALL BUNGEE BRACKETS

6.1 Attach Bungee Brackets (optional): If you purchased **Bungee Brackets** for your **Wheel Well Box**, attach them to the pre-drilled holes along the inside of the **Bamboo Top** using (3ea) **#6 X 0.375 Round Head Phillips Drive Screws** (FIG 31).

NOTE - If the pre-drilled holes don't align with those of the **Molle Panel** (FIG 32), drill out new holes using a **5/64" or similar sized bit** (FIG 33). Make sure you only drill them out enough to thread in the screws and not all the way through the **Bamboo Top**.

TOOLS REQUIRED FOR THIS STEP: + PHILLIPS SCREWDRIVER
+ POWER DRILL
+ 5/64" DRILL BIT



FIG 31



FIG 32



FIG 33

STEP | 06 INSTALL BUNGEE BRACKETS

6.2 Attach Bungee to Brackets (optional): Attach Bungee to Brackets by tying off one end (FIG 34), threading it up and down through the first available holes (FIG 35+36), leapfrogging back and forth until you reach the last hole adjacent to the one you started with (FIG 37). Tie off and trim to desired tension.

NOTE - You can use whatever method you like best for the Bungee, but this is how we recommend doing it.

TOOLS REQUIRED FOR THIS STEP: + PHILLIPS SCREWDRIVER
+ POWER DRILL
+ 5/64" DRILL BIT



FIG 34



FIG 35



FIG 36



FIG 37

STEP | 07 INSTALL BOX TO VAN

7.1 Install Wheel Well Box to Van: There are *vertical* and *horizontal* slots cutout of the **Wheel Box** that are sized to accept **3/8" and 1/4" Hardware (FIG 38)**. Use your preferred mounting method to attach the **Wheel Box** to the location you've chosen in the van.

TOOLS REQUIRED FOR THIS STEP:

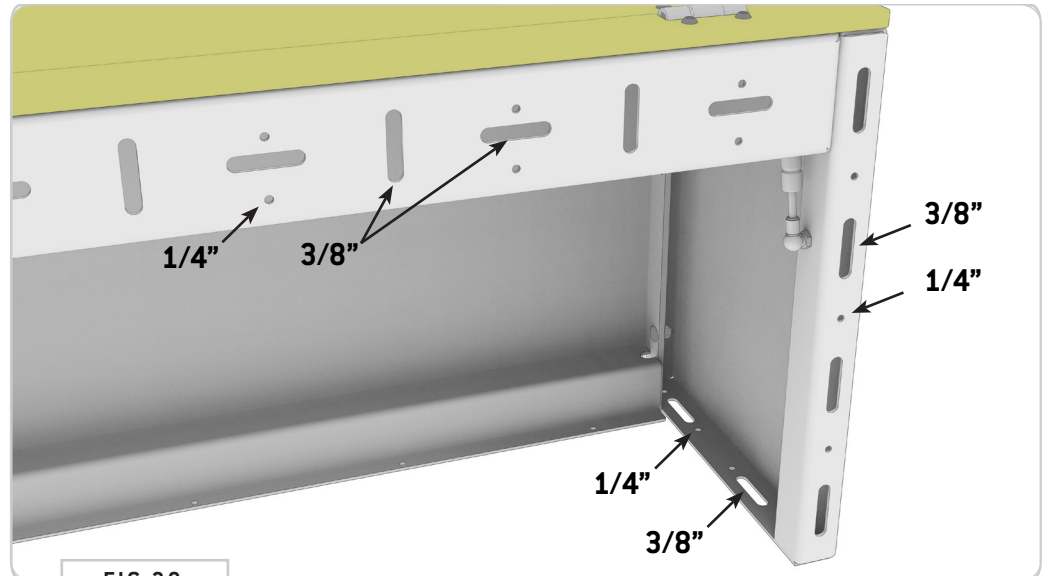

FIG 38



FIG 39

GET OUT AND EXPLORE!

+ LEAVE US A REVIEW

Happy with your new FVC product? We would love to hear (and see) from you! Head to the product page and click "Leave Review." Add a short review and upload a few photos to be showcased on the product page.

+ SHARE YOUR PICS

We love seeing how our customers use their FVC products and following along with your adventures. Tag us in your photos with: @flatlinevanco or send them to us via email. We love posting customer pictures in our feed!

+ NEED ANY HELP?

If you are having any issues with your product, please reach out, and we will make it right. FVC is a company of van and outdoor enthusiasts that design and use our own products, so we want you to be as stoked on your new parts as we are!



@FLATLINEVANCO