



INSTALLATION GUIDE

UNIVERSAL STARLINK MINI MOUNT - STEEL UN0123B



TOOLS REQUIRED (NOT INCLUDED)

- + 5/32" ALLEN WRENCH
- + 7/16" WRENCH OR SOCKET

INSTALL INFO

TIME TO INSTALL THIS PRODUCT: 30 MINUTES

Additional help is suggested for a few of the install steps.

BEFORE YOU START

Please inspect the product and packaging upon delivery to ensure there are no issues and that all parts and hardware are accounted for.

Contact us ASAP if anything is missing at:
support@flatlinevanco.com

BEFORE YOU START

All Flatline Van Co products must be properly assembled and secured before attaching to your vehicle. Improper attachment could result in an automobile accident, and could cause serious bodily injury or death to you or to others involved. You are responsible for assembling and securing Flatline Van Co products to your vehicle, checking the mounting points and attachments prior to use, and regularly inspecting the products for wear and or damage. We always recommend you use a professional to install any aftermarket accessories to your vehicle. If you have no mechanical experience and are not thoroughly familiar with the installation procedures, you must have the product installed by a professional installer or other qualified persons. The responsibility is yours and must be taken seriously for everyone's safety.



PACKAGE CONTENTS

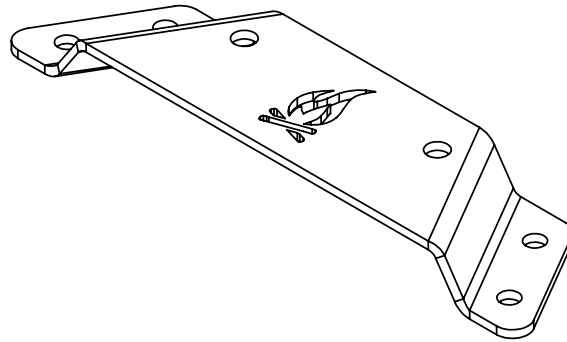

STEEL MINI MOUNT BRACKET

QTY: 1

HARDWARE

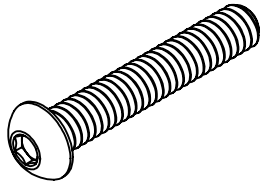

1/4-20 X 1.5 BUTTON HEAD
HEX DRIVE SCREW

QTY: 2

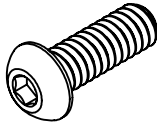

1/4-20 X 0.75 BUTTON
HEAD HEX DRIVE SCREW

QTY: 4

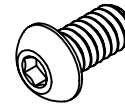

1/4-20 X 0.5 BUTTON HEAD
HEX DRIVE SCREW

QTY: 4

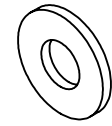

1/4 SCREW FLAT WASHER

QTY: 6



1/4 SCREW BELLEVILLE
SPRING LOCK WASHER

QTY: 4

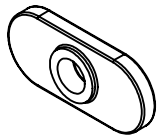

1/4-20 ECONOMY T-NUT

QTY: 4

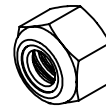

1/4-20 NYLON LOCKNUT

QTY: 2

INSTALL

STEP | 01 LAYOUT AND INSTALL PREP

1.1 Determine Mounting Location: Choose a mounting location along the **Crossbars** of your **Roof Rack**. Make sure there is enough room for the **FVC Mini Mount Bracket** and the **Starlink** itself (**FIG 1-2**).

NOTE - The **FVC Starlink Mini Mount** is designed to be attached to the **80/20 Crossbars** that are utilized for all **FVC Roof Racks**.

TOOLS REQUIRED FOR THIS STEP:

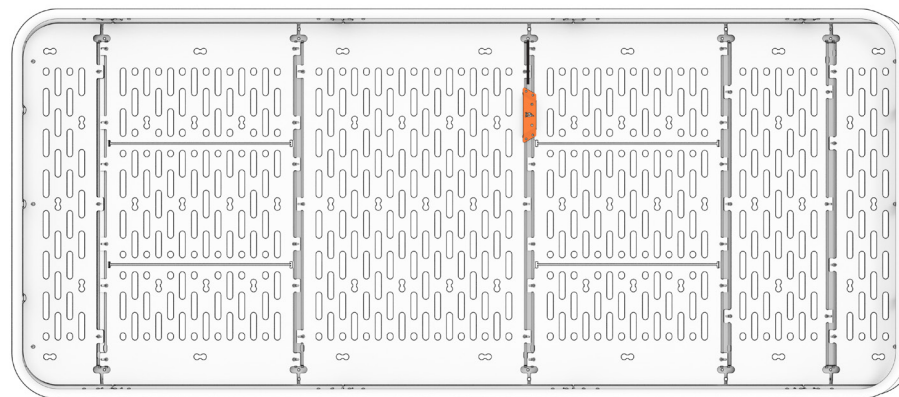

FIG 1

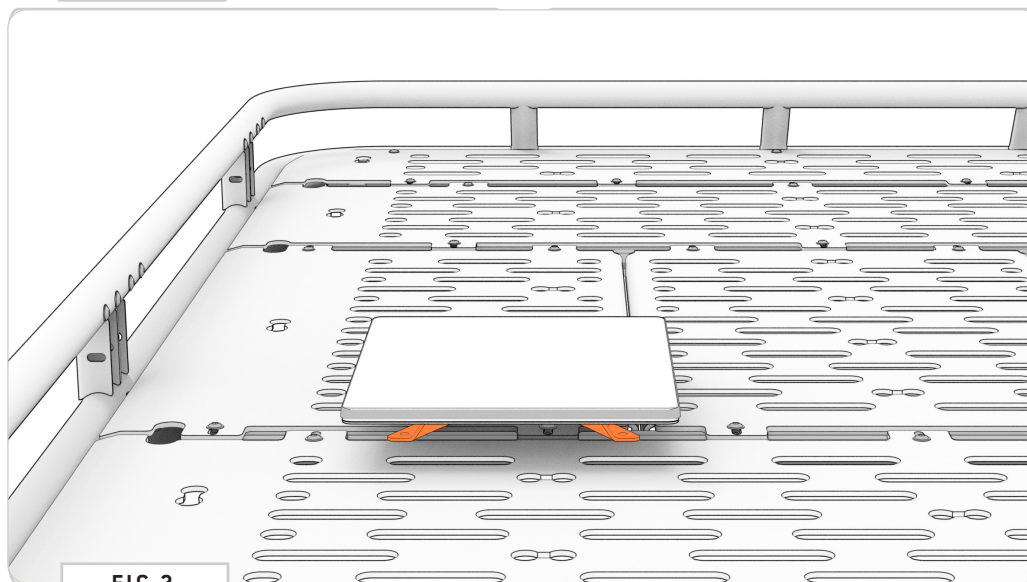

FIG 2

TOOLS REQUIRED FOR THIS STEP: + 5/32" ALLEN WRENCH
+ 7/16" WRENCH OR SOCKET

STEP | 02 ASSEMBLE MINI MOUNT

2.1 Assemble FVC Starlink Mini Mount: Using the provided 1/4-20 X 1.5" Button Head Screws, Flat Washers and Nylon Locknuts, attach your Starlink Kickstand to the FVC Starlink Mini Mount Bracket (FIG 3-4).

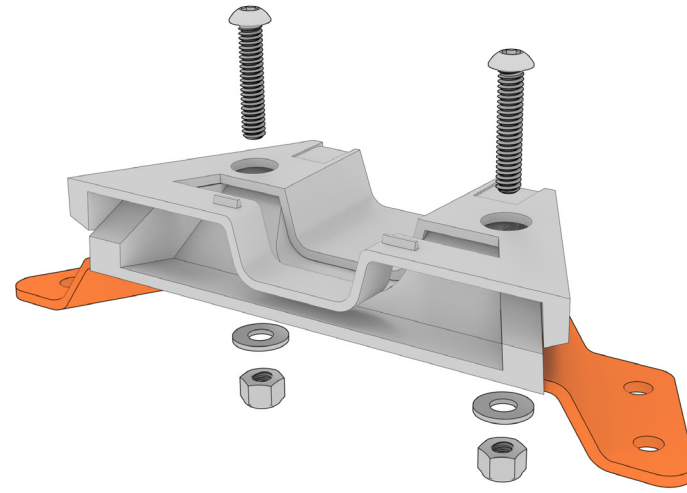

FIG 3



FIG 4

TOOLS REQUIRED FOR THIS STEP: + 5/32" ALLEN WRENCH

STEP | 03 INSTALL FVC MINI MOUNT

3.1 Insert T-Nuts : Remove any accessories or decking panels that obstruct access to the **T-Nut Cutouts** of your **Roof Rack Crossbars**. Insert **(2ea) 1/4-20 T-Nuts** into each of the cutouts and slide into position for the install of your **FVC Starlink Mini Mount** (FIG 5).

3.2 Secure Mini Mount: Secure the **FVC Starlink Mini Mount** to the **Crossbars** using stacks of **1/4-20 x 0.5 Button Head Hex Drive Screws, Flat Washers and Belleville Lock Washers**.

NOTE - Replace the **shorter** screws with the **1/4-20 x 0.75 Button Head Hex Drive Screws** if you're attaching the **Mini Mount** through **Decking Panels**.

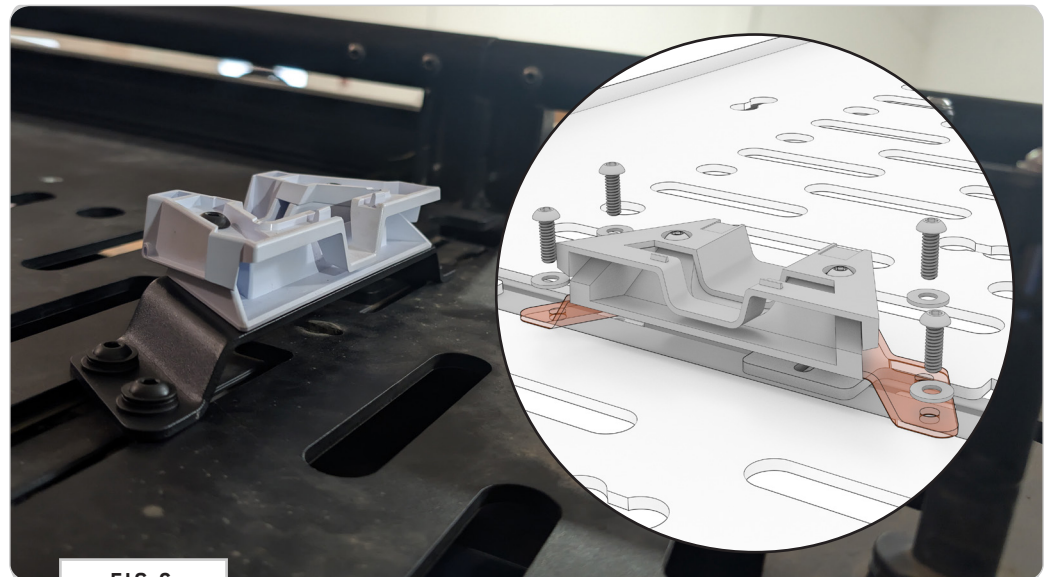
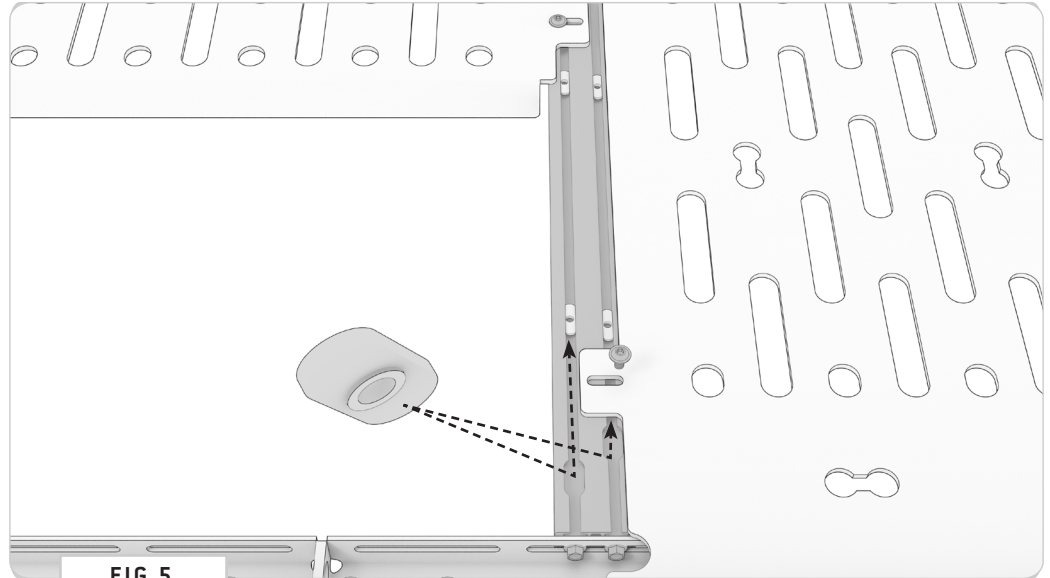

TOOLS REQUIRED FOR THIS STEP: + 5/32" ALLEN WRENCH

STEP | 04 INSTALL STARLINK MINI

3.1 Install Starlink Mini: Slide your **Starlink Mini** onto the **Kickstand** as you normally would and check that everything is mounted securely (FIG 7-8).

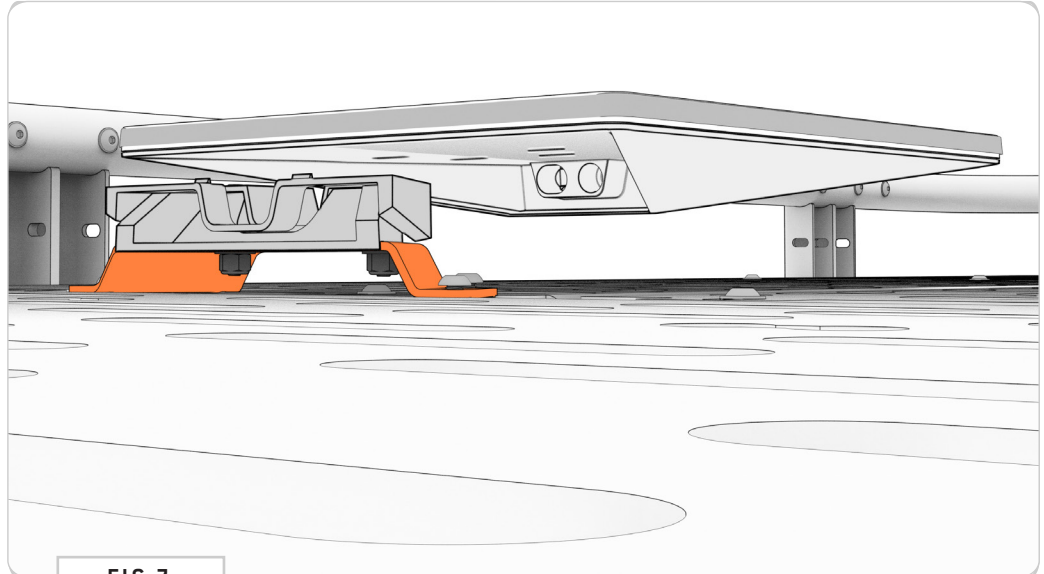

FIG 7

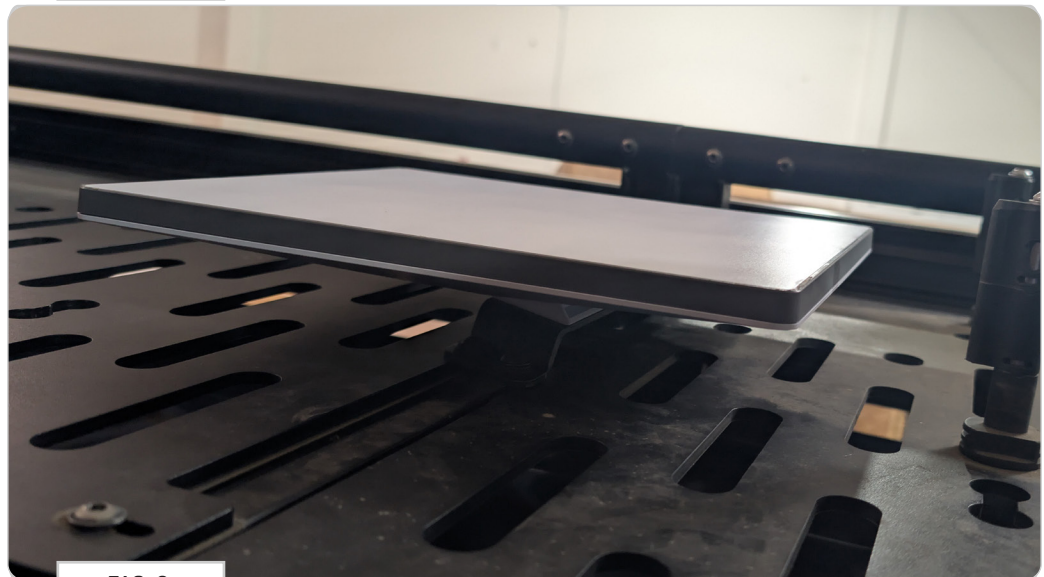

FIG 8

GET OUT AND EXPLORE!

+ LEAVE US A REVIEW

Happy with your new FVC product? We would love to hear (and see) from you! Head to the product page and click "Leave Review." Add a short review and upload a few photos to be showcased on the product page.

+ SHARE YOUR PICS

We love seeing how our customers use their FVC products and following along with your adventures. Tag us in your photos with: @flatlinevanco or send them to us via email. We love posting customer pictures in our feed!

+ NEED ANY HELP?

If you are having any issues with your product, please reach out, and we will make it right. FVC is a company of van and outdoor enthusiasts that design and use our own products, so we want you to be as stoked on your new parts as we are!



@FLATLINEVANCO