



Installation Guide



Transit Rear Door Platform TR1105B

All Flatline Van Co products must be properly assembled and secured before attaching to your vehicle. Improper attachment could result in an automobile accident, and could cause serious bodily injury or death to you or to others involved. You are responsible for assembling and securing Flatline Van Co products to your vehicle, checking the mounting points and attachments prior to use, and regularly inspecting the products for wear and or damage. We always recommend you use a professional to install any aftermarket accessories to your vehicle. If you have no mechanical experience and are not thoroughly familiar with the installation procedures, you must have the product installed by a professional installer or other qualified persons. The responsibility is yours and must be taken seriously for everyone's safety.



thanks.

THANK YOU!

ARE YOU EXCITED ABOUT YOUR NEW REAR DOOR PLATFORM? HERE ARE A FEW THINGS TO DO BEFORE BEGINNING THE INSTALLATION PROCESS--

- PLEASE INSPECT THE PRODUCT TO ENSURE THERE WAS NO DAMAGE INCURRED DURING SHIPPING.
- IF THERE IS DAMAGE TO REPORT, PLEASE CONTACT OUR CUSTOMER SERVICE DEPARTMENT AS SOON AS POSSIBLE.
- NEXT, USING THE "PACKAGE CONTENTS" PAGE, CHECK INVENTORY AND FAMILIARIZE YOURSELF WITH THE PARTS AND HARDWARE.
- GATHER ALL TOOLS REQUIRED FOR INSTALL.
 - RATCHET
 - 13MM SOCKET
 - 9/16 BOX WRENCH OR SOCKET
 - 7/32 HEX KEY ALLEN WRENCH
 - POWER DRILL
 - 3/16" DRILL BIT
 - 27/64" DRILL BIT
 - PLASTIC TRIM PIECE REMOVAL KIT (OPTIONAL)

ESTIMATED INSTALL TIME- 2 HRS

ADDITIONAL HELP IS SUGGESTED FOR A FEW OF THE INSTALL STEPS.

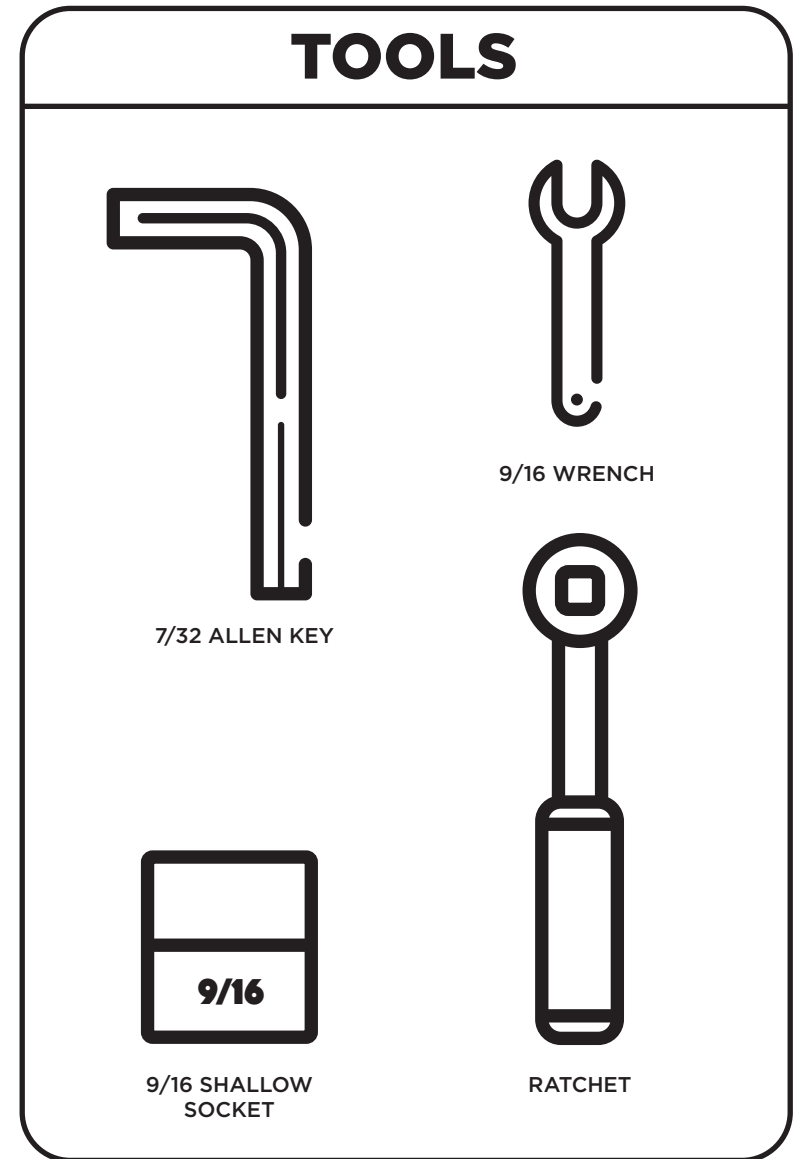

PACKAGE CONTENTS

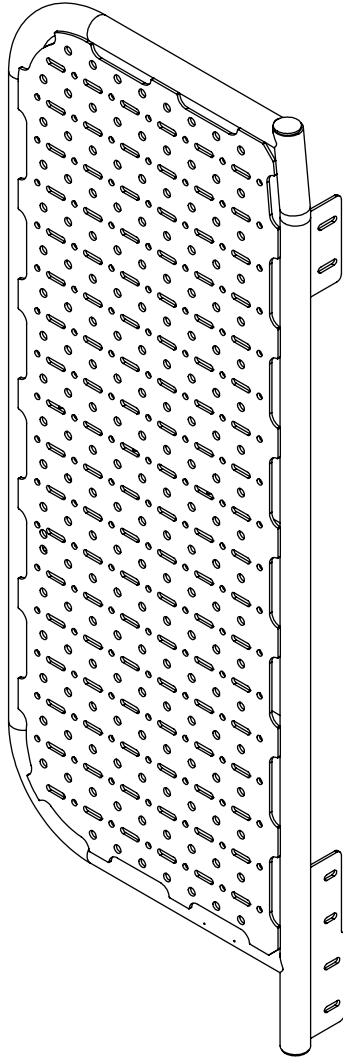

REAR DOOR PLATFORM

QTY - 1

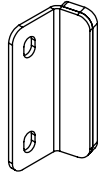

**LOWER FRAME
BRACE**

QTY - 1

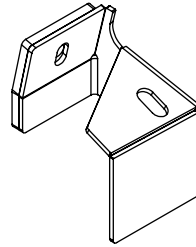

DOOR BACKER

QTY - 1

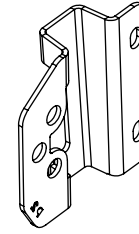

**PASSENGER BOTTOM
HINGE BRACKET**

QTY - 1

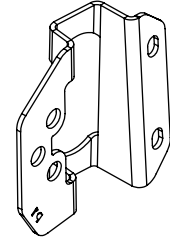

**PASSENGER TOP
HINGE BRACKET**

QTY - 1

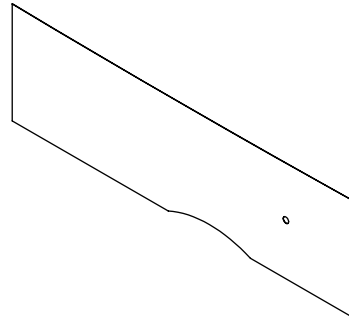

**EXTERIOR DRILL
TEMPLATE**

QTY - 1

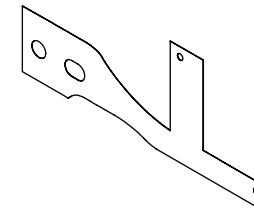

**INTERIOR DRILL
TEMPLATE**

QTY - 1

HARDWARE

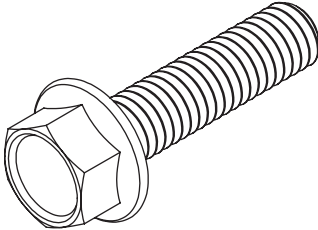

**3/8-16 X 1.5 FLANGED HEX
HEAD SCREW**

QTY - 1

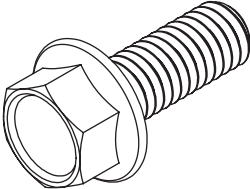

**3/8-16 X 1 FLANGED
HEX HEAD SCREW**

QTY - 6

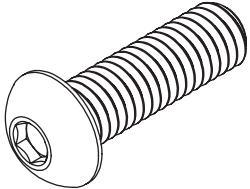

**3/8-16 X 1.25 BUTTON
HEAD HEX DRIVE
SCREW**

QTY - 1

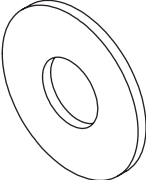

3/8 OVERSIZED FLAT WASHER

QTY - 1

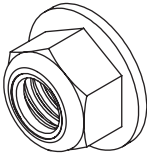

**3/8-16 FLANGED
NYLON INSERT
LOCKNUT
(MAY BE SUBSTITUTED FOR NUT AND WASHER)**

QTY - 8

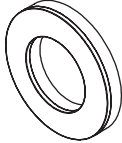

**3/8 SCREW BONDED
SEALING WASHER**

QTY - 1

LET'S GET STARTED!

WE SUGGEST HAVING A HELPING HAND WITH THESE FIRST FEW STEPS TO HELP SUPPORT THE DOOR!

1. STARTING WITH THE BOTTOM HINGE ON YOUR PASSENGER SIDE DOOR- MAKE SOME ALIGNMENT MARKS WITH A SHARPIE OR MARKER, AND THEN REMOVE THE 3 FACTORY BOLTS WITH A 13MM SOCKET. HAVE SOMEONE SUPPORT THE DOOR FOR YOU AND THEN SWING THE HINGE BACK AS SHOWN IN **FIGURE 2** SO YOU CAN SLIDE THE **P2 HINGE BRACKET** OVER THE HINGE. THEN REINSTALL THE FACTORY BOLTS AND SNUG DOWN. CHECK CLEARANCES BY SLOWLY CLOSING THE DOOR; IF ALL IS CLEAR THEN TIGHTEN DOWN THE BOLTS.

NOTE- SOME MANIPULATION OF THE BRACKET AND HINGE MAY BE NECESSARY TO GET THE BRACKET SEATED CORRECTLY ON TOP OF THE HINGE AND THE HINGE BACK IN PLACE.

2. REPEAT THE SAME PROCESS ON THE UPPER HINGE USING THE P1 HINGE BRACKET. ENSURE THAT THE DOOR IS SAFELY SUPPORTED AND DOES NOT TWIST WHEN UNBOLTING THE HINGE. ONCE THE UPPER HINGE BRACKET IS INSTALLED, TEST DOOR FUNCTION AND MAKE SURE THERE IS NO CONTACT WITH THE DOOR OR BODY OF THE VAN DURING OPERATION.

FIGURE 2



FIGURE 1



**MAKE
ALIGNMENT
MARKS**

FIGURE 3



FIGURE 4



- 3. NEXT, YOU WILL NEED TO REMOVE THE INTERIOR DOOR PANEL. WE RECOMMEND USING SOME PLASTIC PANEL REMOVAL TOOLS (EASILY FOUND AT HARBOR FREIGHT OR SIMILAR) BE GENTLE WHEN PRYING AS TO NOT BREAK THE FACTORY PANEL CLIPS. ONCE YOU GET THE FIRST FEW POPPED YOU SHOULD BE ABLE TO PULL IT THE REST OF THE WAY WITH YOUR HANDS.

NOTE- SOMETIMES THE CLIPS WILL GET STUCK IN THE DOOR. ALL YOU NEED TO DO IS POP THEM OUT AND SLIDE THEM BACK IN TO THEIR LOCATION ON THE TRIM PANEL.

- 4. WITH THE DOOR TRIM REMOVED; YOU WILL SEE THE FACTORY VAPOR BARRIER. YOU WILL WANT TO SLOWLY PEEL BACK THE TOP RIGHT CORNER BEING CAREFUL TO KEEP THE ADHESIVE ON THE VAPOR BARRIER TO MAKE RE-INSTALLATION EASIER. PEEL IT BACK ABOUT HALFWAY.

FIGURE 5



PEEL THIS CORNER

TRIM PANEL REMOVAL TOOLS



FIGURE 6

5. NOW GRAB YOUR **EXTERIOR DRILL TEMPLATE** AND LINE IT UP WITH THE EDGE OF THE DOOR AND EDGE OF SHEET METAL UNDER THE WINDOW (OR WINDOW SPACE) AND MARK YOUR HOLE TO DRILL.

6. GRAB YOUR DRILL AND START BY DRILLING A HOLE WITH YOUR PILOT BIT, THEN FINISH THE HOLE WITH THE 27/64" DRILL BIT. WE RECOMMEND DEBURRING THE HOLE WITH A DEBURRING TOOL OR COUNTERSINK, AND THEN PAINTING THE EXPOSED EDGES WITH A RUST PREVENTATIVE PAINT.

FIGURE 7

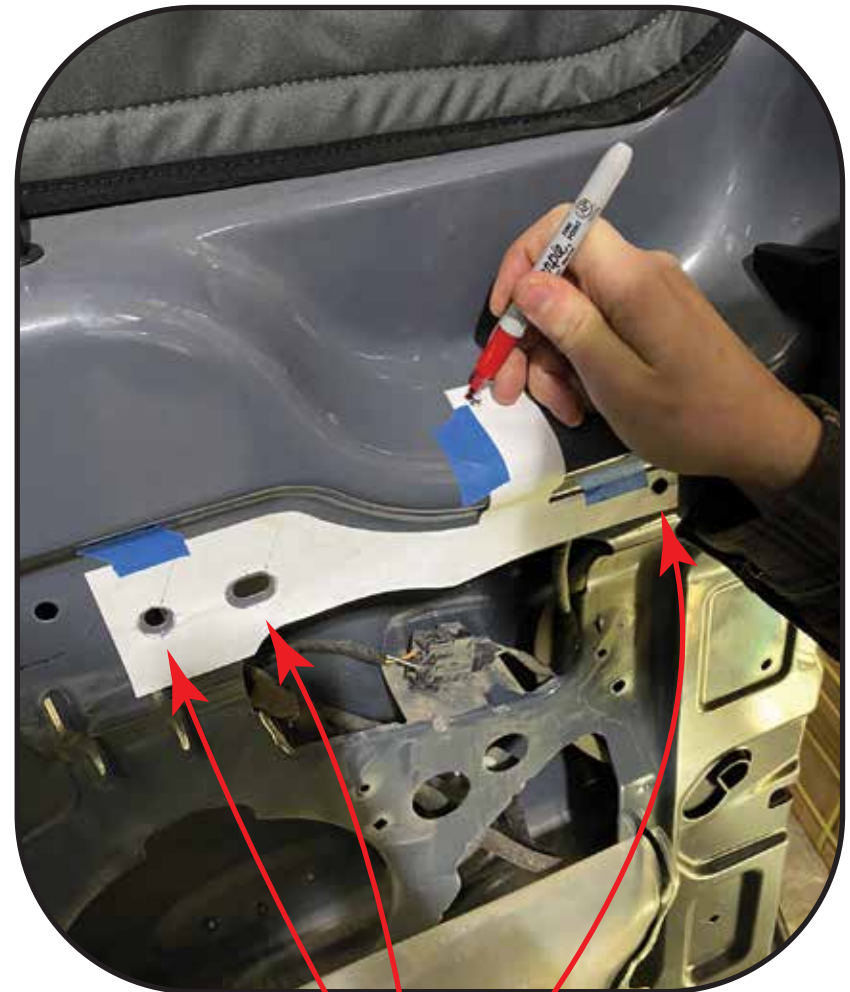

FIGURE 8

7. NEXT WE DRILL THE INSIDE MOUNT HOLE. LINE UP THE **INTERIOR DRILL TEMPLATE** AS SHOWN TO THE RIGHT, TAKING CARE TO ALIGN IT WITH THE EXISTING HOLES IN THE DOOR. THE TEMPLATE IS DESIGNED TO WRAP AROUND THE SHEET METAL AS SHOWN. THE STRIP SHOULD MAKE FULL CONTACT WITH THE SHEET METAL OF THE DOOR THROUGHOUT THE WRAP.

8. ONCE MORE, GRAB YOUR DRILL AND START BY DRILLING A HOLE WITH YOUR PILOT BIT, THEN FINISH THE HOLE WITH THE 27/64" DRILL BIT. WE RECOMMEND DEBURRING THE HOLE WITH A DEBURRING TOOL OR COUNTERSINK, AND THEN PAINTING THE EXPOSED EDGES WITH A RUST PREVENTATIVE PAINT.

FIGURE 9



**ALIGN THESE
3 HOLES**

FIGURE 10

9. NOW IT'S TIME TO GET THE **DOOR PLATFORM** BOLTED UP. HAVE SOMEONE HELP YOU BY INSERTING THE HARDWARE AS SHOWN WHILE HOLDING THE **DOOR PLATFORM** IN PLACE. LEAVE THE HARDWARE LOOSE FOR NOW.



FIGURE 11

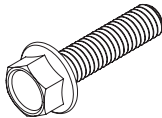

3/8-16 X 1.5 FLANGED HEX HEAD SCREW

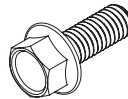

3/8-16 X 1 FLANGED HEX HEAD SCREW



3/8 SCREW BONDED SEALING WASHER



3/8-16 FLANGED NYLON INSERT LOCKNUT

FIGURE 12

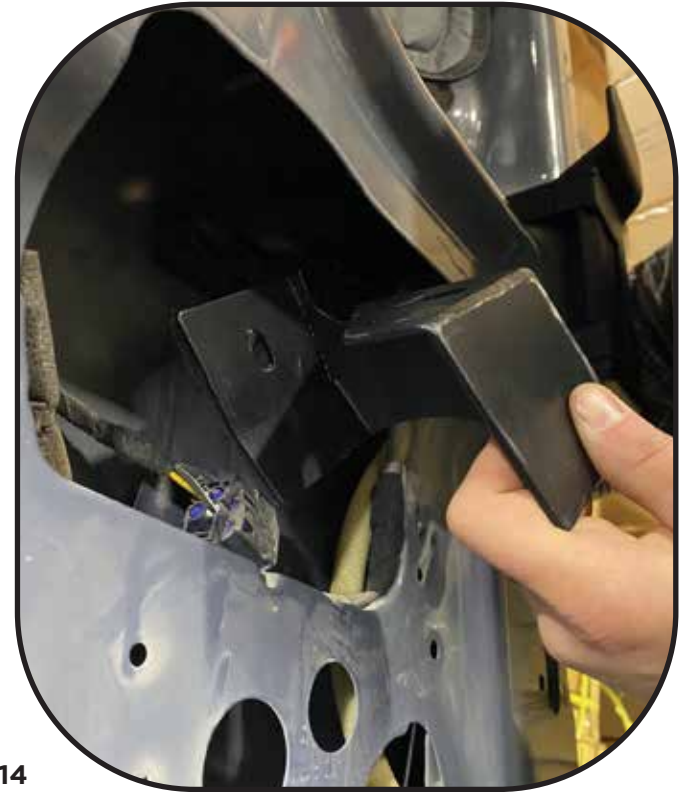

10. NEXT WE INSTALL THE **DOOR BACKER**. THE FLANGE WITH THE NEOPRENE PAD GOES AGAINST THE OUTER DOOR SKIN. SLIP IT OVER THE BOLT PROTRUDING FROM THE DOOR MOUNT ON THE **DOOR PLATFORM** AND THEN ALIGN IT WITH THE INSIDE MOUNT HOLE YOU MADE IN THE WINDOW SHELF OF THE DOOR. DROP IN THE **3/8-16 X 1.25 BUTTON HEAD HEX DRIVE SCREW** WITH THE **3/8 OVERSIZED FLAT WASHER** UNDERNEATH THE HEAD OF THE BOLT THREAD A **3/8-16 FLANGED NYLON INSERT LOCKNUT** ONTO BOTH BOLTS AND TIGHTEN DOWN.

FIGURE 13



FIGURE 14

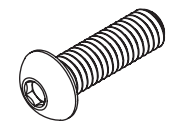

3/8-16 X 1.25 BUTTON
HEAD HEX DRIVE
SCREW



3/8 OVERSIZED FLAT WASHER

11. TIGHTEN THE 4 BOLTS ON THE HINGE BRACKETS.

12. LASTLY, GRAB THE **LOWER FRAME BRACE**, AND ATTACH IT USING THE REMAINING **3/8-16 X 1 FLANGED HEX HEAD SCREWS** AND **3/8-16 FLANGED NYLON INSERT LOCKNUTS**. ENSURE THAT THE BRACE IS BUTTED TIGHT TO THE DOOR AND TIGHTEN DOWN.

FIGURE 15

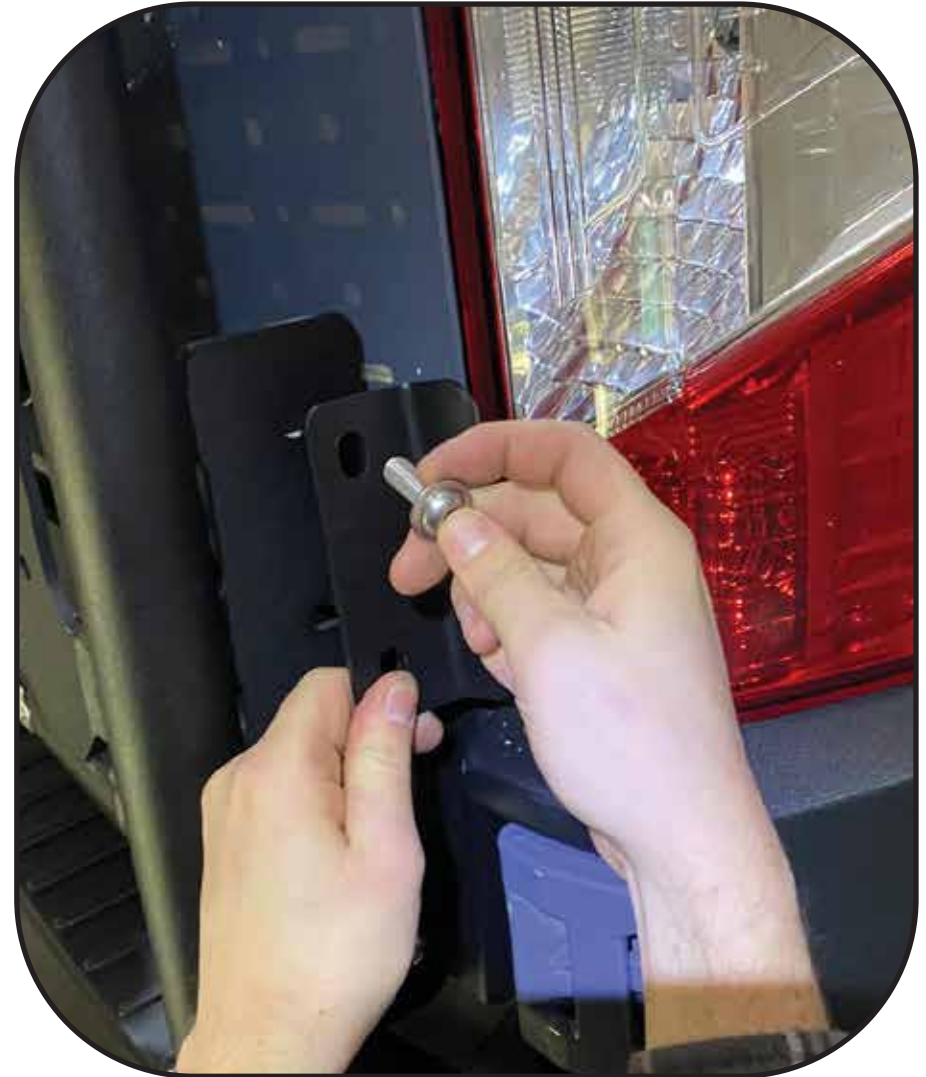

GET OUT AND EXPLORE!

LEAVE US A REVIEW

Happy with your new FVC product? We would love to hear (and see) from you! Head to the product page and click "Leave Review." Add a short review and upload a few photos to be showcased on the product page.

SHARE YOUR PHOTOS WITH US

We love seeing how our customers use their FVC products and following along with your adventures. Tag us in your photos with @flatlinevanco or send them to us via email. We love posting customer pictures in our feed!

CUSTOMER SUPPORT

If you are having any issues with your product, please reach out, and we will make it right. FVC is a company of van and outdoor enthusiasts that design and use our own products, so we want you to be as stoked on your new parts as we are!



@flatlinevanco



facebook.com/flatlinevanco



youtube.com/c/flatlinevanco



support@flatlinevanco.com



thanks!