



INSTALLATION GUIDE

SPRINTER SKID PLATE - LIFTED ALL WHEEL DRIVE

SP1161B



TOOLS REQUIRED (NOT INCLUDED)

- + 13MM WRENCH OR SOCKET
- + 9/16" WRENCH AND SOCKET
- + 7/32" ALLEN WRENCH
- + 5/32" ALLEN WRENCH
- + 5MM ALLEN WRENCH

INSTALL INFO

TIME TO INSTALL THIS PRODUCT: 30 MINUTES

Additional help is suggested for a few of the install steps.

BEFORE YOU START

Please inspect the product and packaging upon delivery to ensure there are no issues and that all parts and hardware are accounted for.

Contact us ASAP if anything is missing at:
support@flatlinevanco.com

BEFORE YOU START

All Flatline Van Co products must be properly assembled and secured before attaching to your vehicle. Improper attachment could result in an automobile accident, and could cause serious bodily injury or death to you or to others involved. You are responsible for assembling and securing Flatline Van Co products to your vehicle, checking the mounting points and attachments prior to use, and regularly inspecting the products for wear and or damage. We always recommend you use a professional to install any aftermarket accessories to your vehicle. If you have no mechanical experience and are not thoroughly familiar with the installation procedures, you must have the product installed by a professional installer or other qualified persons. The responsibility is yours and must be taken seriously for everyone's safety.



PACKAGE CONTENTS

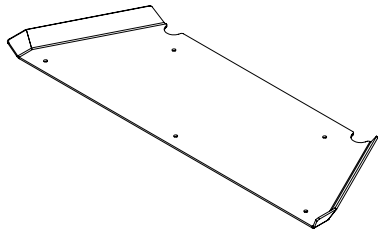

SKID PLATE

QTY: 1

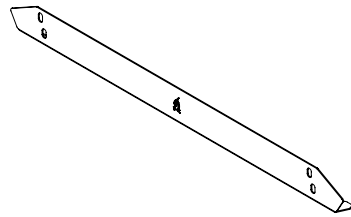

SKID PLATE FRONT
BRACKET

QTY: 1

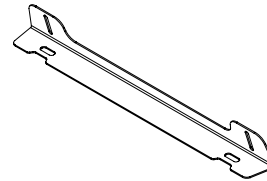

SKID PLATE LOWER
BRACKET

QTY: 1

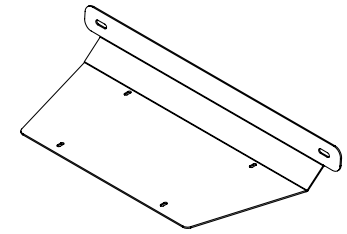

AWD SKID PLATE BRACKET

QTY: 1

HARDWARE

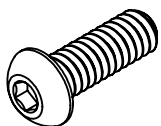

1/4-20 X 0.75 BUTTON HEAD
HEX DRIVE SCREW

QTY: 4

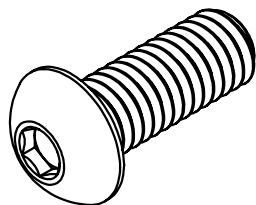

3/8-16 X 1 BUTTON HEAD
HEX DRIVE SCREW

QTY: 5

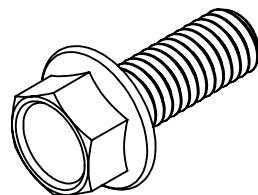

3/8-16 X 1 FLANGED HEX
HEAD SCREW

QTY: 2

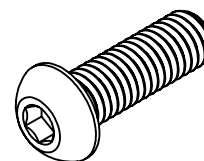

M8-1.25 X 25 BUTTON HEAD
HEX DRIVE SCREW

QTY: 4



1/4 SCREW FLAT WASHER

QTY: 4

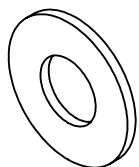

3/8 SCREW FLAT WASHER

QTY: 4

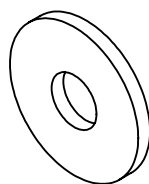

M8 SCREW X 24 O.D.
OVERSIZED FLAT WASHER

QTY: 4

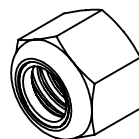

3/8-16 NYLON INSERT
LOCKNUT

QTY: 2

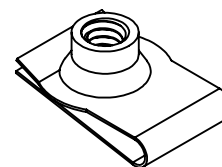

1/4-20 X 0.531 CLIP NUT

QTY: 4

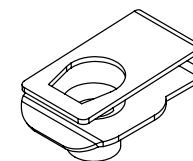

3/8-16 CLIP NUT

QTY: 5

TOOLS REQUIRED FOR THIS STEP:

STEP | 01 LAYOUT AND INSTALL PREP

1.1 Verify Vehicle Configuration: Before the install of your **Skid Plate**, ensure your van has the required over run brackets installed (**FIG 1**). These provide the necessary mounting points for the skid plate's fitment to the van.

1.2 Install Required Brackets (If Missing): If your van does not have these brackets, you will need to install the **SP1158B Sprinter Frame Rail Support Brackets** before proceeding with the skid plate.



FIG 1



FIG 2

TOOLS REQUIRED FOR THIS STEP: + 13MM WRENCH OR SOCKET

STEP | 02 REMOVE OEM COMPONENTS

2.1 Remove Over Run Crossbar: Using a 13MM Socket Or Wrench, remove the factory over run crossbar if it is currently installed on your van (FIG 3-4).

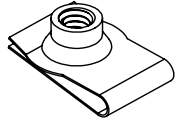

FIG 3



FIG 4

HARDWARE:



TOOLS REQUIRED FOR THIS STEP:

STEP | 03 AWD SKID PLATE INSTALL

3.1 Attach Clip Nuts to Frame: Attach 1/4-20" Clip Nuts to the van's frame in the locations shown in FIG 5-6.

NOTE - Make sure that the "barrel" of the clip nut is facing upwards.

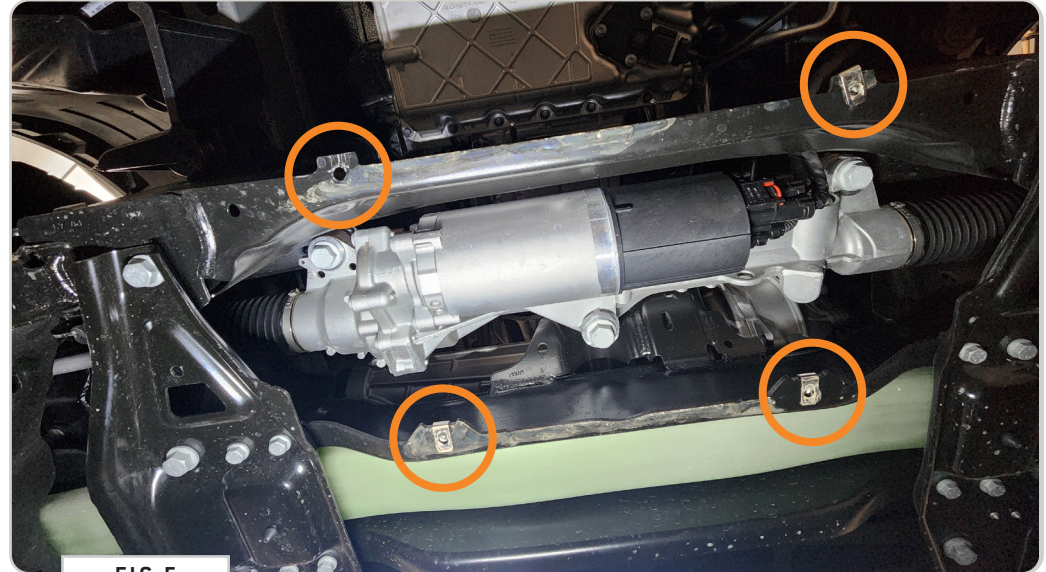
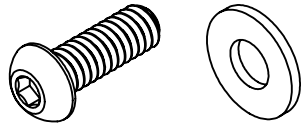

FIG 5



FIG 6

HARDWARE:



TOOLS REQUIRED FOR THIS STEP: + 5/32" ALLEN WRENCH

STEP | 03 AWD SKID PLATE INSTALL

3.2 Attach AWD Skid Plate to Van: Loosely attach the AWD Skid Plate Bracket to the Clip Nuts using (4) 1/4 X 0.75 Flanged Hex Head Screws with Washers through the available mounting slots (FIG 7-8).

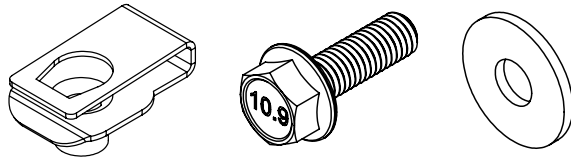

FIG 7



FIG 8

HARDWARE:



TOOLS REQUIRED FOR THIS STEP: + 9/16" WRENCH AND SOCKET

STEP | 03 AWD SKID PLATE INSTALL

3.3 Attach Clip Nuts to Lower Mounting Bracket: Attach 3/8-16" Clip Nuts to the Lower Skid Plate Bracket with the "barrel" facing upwards (FIG 9).

3.4 Attach AWD Skid Plate Bracket to Lower Mounting Bracket: Loosely attach the Lower Skid Plate Bracket to the AWD Skid Plate Bracket using (2ea) 3/8-16 x 1 Hex Head Screws, 3/8" Flat Washers and Nylon Locknuts through the available mounting slots (FIG 10).

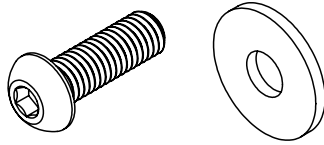

FIG 9



FIG 10

HARDWARE:



TOOLS REQUIRED FOR THIS STEP: + 5MM ALLEN WRENCH

STEP | 03 AWD SKID PLATE INSTALL

3.5 Secure Front Bracket: Using a 5MM Allen Wrench, install the screws through the **Front Mounting Bracket** and into the over run brackets (**FIG 11-12**).

NOTE - *If you're installing a **Bull Bar** in addition to the **Skid Plate**, you can skip this step.*

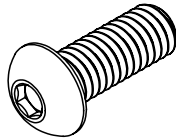

FIG 11



FIG 12

HARDWARE:



TOOLS REQUIRED FOR THIS STEP: + 7/32" ALLEN WRENCH

STEP | 04 INSTALL FVC BULL BAR

4.1 Attach Skid Plate to Van: Secure the **Skid Plate Bracket** to the **Clip Nuts** of both the **Front and Rear Mounting Brackets** using (5) **3/8-16 X 1 Button Head Hex Head Screws with Washers** through the available mounting slots (**FIG 13-14**).

4.2 Integrate Bull Bar (Optional): If you are installing a **Bull Bar**, sandwich the **Skid Plate's** front mounting bracket between the bull bar and the over run brackets. Use the screws supplied with the **Bull Bar** to pass through the bull bar bracket and the skid plate bracket into the over run points. There may be some adjustment necessary in the **Bull Bar/ Skid Plate** for the mounting holes to line up.



FIG 13



FIG 14

HARDWARE:

TOOLS REQUIRED FOR THIS STEP:

STEP | 05 FINAL CHECKS

5.1 Align and Tighten Hardware: There is quite a bit of adjustment built into the **Mounting Brackets** of the **Skid Plate**. Determine your desired fit and fully tighten up all fasteners.



FIG 15

GET OUT AND EXPLORE!

+ LEAVE US A REVIEW

Happy with your new FVC product? We would love to hear (and see) from you! Head to the product page and click "Leave Review." Add a short review and upload a few photos to be showcased on the product page.

+ SHARE YOUR PICS

We love seeing how our customers use their FVC products and following along with your adventures. Tag us in your photos with: @flatlinevanco or send them to us via email. We love posting customer pictures in our feed!

+ NEED ANY HELP?

If you are having any issues with your product, please reach out, and we will make it right. FVC is a company of van and outdoor enthusiasts that design and use our own products, so we want you to be as stoked on your new parts as we are!



@FLATLINEVANCO