



# SERVICE BULLETIN 2025+ SPRINTERS

## SPRINTER FRONT BUMPER ADAPTIVE RADAR BEZEL

SP1127B



### TOOLS REQUIRED (NOT INCLUDED)

- + MARKER
- + MEASURING TAPE
- + AUTO BODY SAW OR ANGLE GRINDER
- + METAL CUTOFF WHEEL OR BLADE
- + METAL FILE
- + 5/32" ALLEN WRENCH
- + 4MM ALLEN WRENCH

### INSTALL INFO

TIME TO MODIFY THIS PRODUCT: 45 MINUTES

### BEFORE YOU START

Please inspect the product and confirm van type to determine that modification is necessary.

Contact us if you have any questions at:

[support@flatlinevanco.com](mailto:support@flatlinevanco.com)

# INSTALL

## STEP | 01 LAYOUT AND INSTALL PREP

**1.1 Confirm Sensor Type:** See FIG 1 for the difference between the 2019-2024 and 2025+ Adaptive Radar Sensors. The updated **Center Bracket** has a notch (FIG 2) cut out to accommodate the fitment of both sensor models. If your **Sprinter Van** is *newer* than 2024, and your **FVC Front Bumper** *doesn't* have the notch, you'll need to cut one out.

TOOLS REQUIRED FOR THIS STEP:

2025+ ADAPTIVE RADAR SENSOR

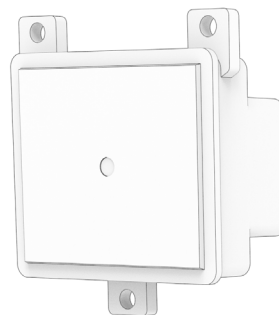

2019-2024 (VS30) ADAPTIVE RADAR SENSOR



FIG 1

NEW SENSOR BEZEL

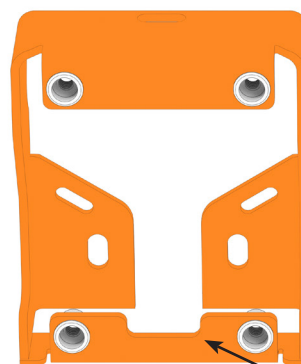

OLD SENSOR BEZEL

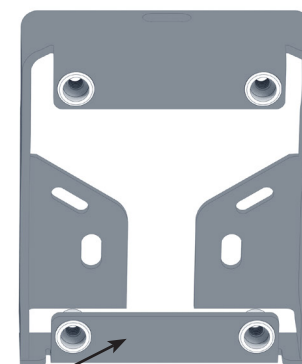

FIG 2

# INSTALL

## STEP | 02 CUT OUT NOTCH

**2.1 Layout Cut Line:** Identify the **Center Bracket** of your **FVC Front Bumper (FIG 3)** and layout your **Cut Line** using a marker and referencing the dimensions shown in **FIG 4**.

**2.1 Cut Out Notch:** Cut out the notch using an **Auto Body Saw** or **Angle Grinder with a Metal Blade or Cutoff Wheel (FIG 5)**.

**NOTE** - The Bumper Skin is aluminum and won't rust, but you can touch up the cut with a Metal File and paint if desired.

### TOOLS REQUIRED FOR THIS STEP:

- + MARKER
- + MEASURING TAPE
- + ANGLE GRINDER OR AUTO BODY SAW
- + METAL BLADE OR CUTOFF WHEEL
- + METAL FILE

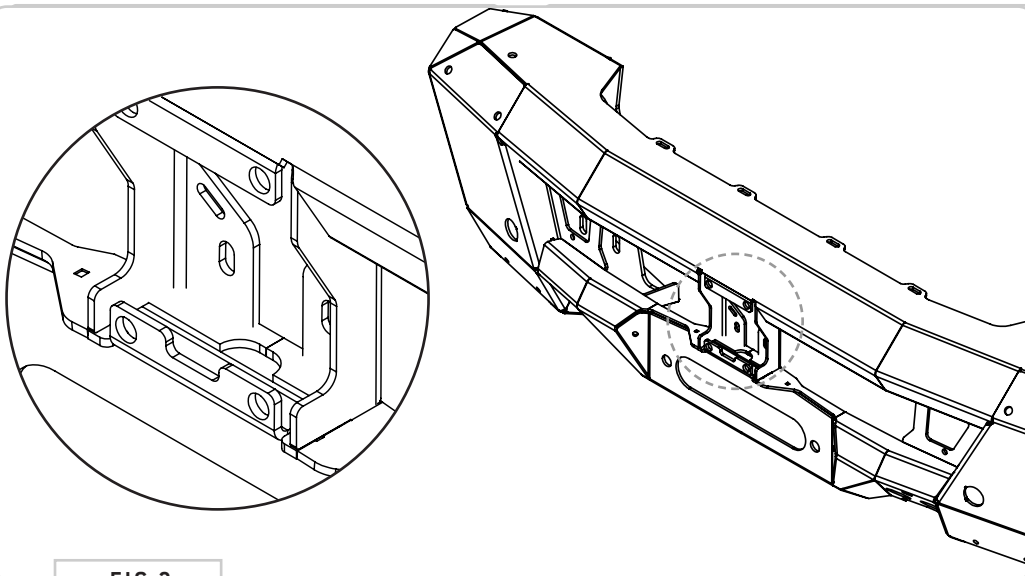

FIG 3

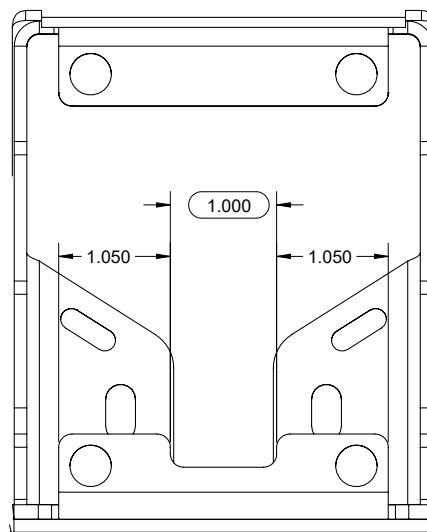

FIG 4

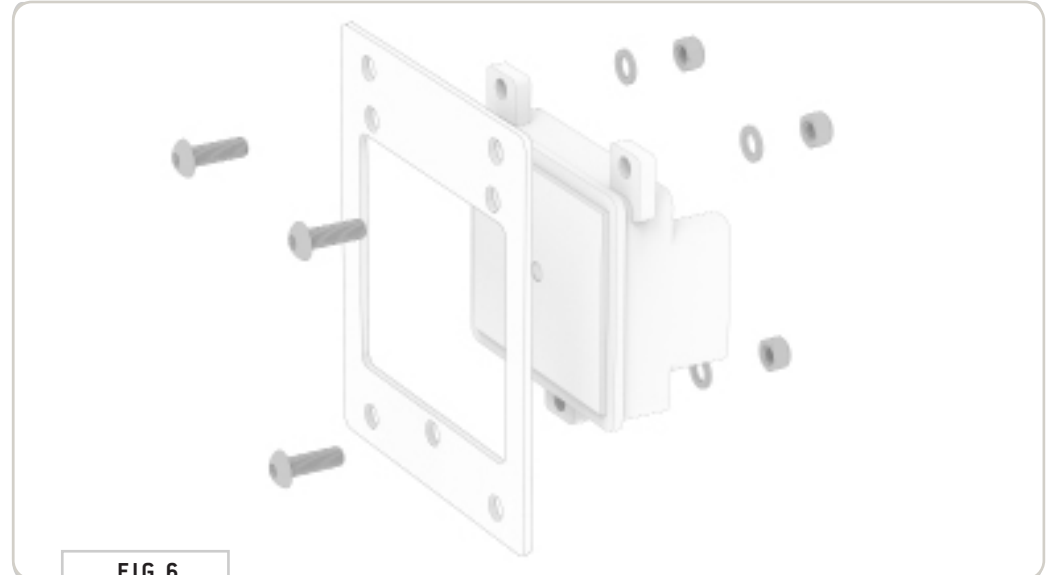

FIG 5

TOOLS REQUIRED FOR THIS STEP: + 4MM ALLEN WRENCH

## STEP | 03 SENSOR COVER ASSEMBLY

**3.1 Attach Adapter Plate to Sensor:** Attach Adapter Plate to Sensor using (3ea) M5-0.8 X 16 Button Head Hex Drive Screws, Flat Washers and Nylon Locknuts (FIG 6+7).



## STEP | 03 SENSOR COVER ASSEMBLY

**3.2 Attach Sensor Cover Faceplate to Sensor Cover:** See FIG 8 for an exploded view of the entire **Sensor Cover** assembly. Begin by inserting **[4] 1/4-20 x 1 Button Head Hex Drive Screws** through the **Sensor Cover** and **Sensor Cover Faceplate**. Complete the stack with **[4] 1/4" Spacers** (FIG 9).

TOOLS REQUIRED FOR THIS STEP:

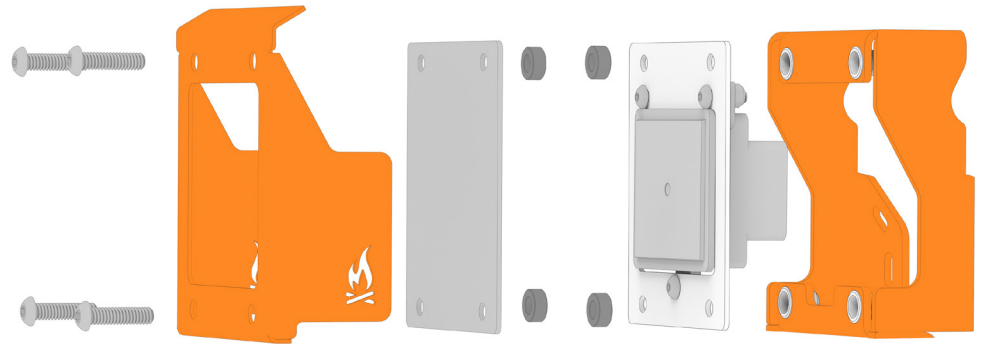

FIG 8



FIG 9



TOOLS REQUIRED FOR THIS STEP:

## STEP | 03 SENSOR COVER ASSEMBLY

**3.3 Attach Sensor Adapter Plate to Sensor Cover Assembly:**  
Attach the **Sensor Adapter Plate** to the four protruding screws of the **Sensor Cover Assembly** (FIG 10+11).



FIG 10



FIG 11

TOOLS REQUIRED FOR THIS STEP: + 5/32" ALLEN WRENCH

## STEP | 04 SENSOR COVER INSTALL

**4.1 Install Sensor Cover Assembly to Center Bezel:** Carefully position the **Sensor Cover Assembly to the Center Bezel** of the **Front Bumper** and thread in the screws to the pre-installed **Rivet Nuts**. Ensure alignment and tighten down using a **5/32" Allen Wrench**.



FIG 12

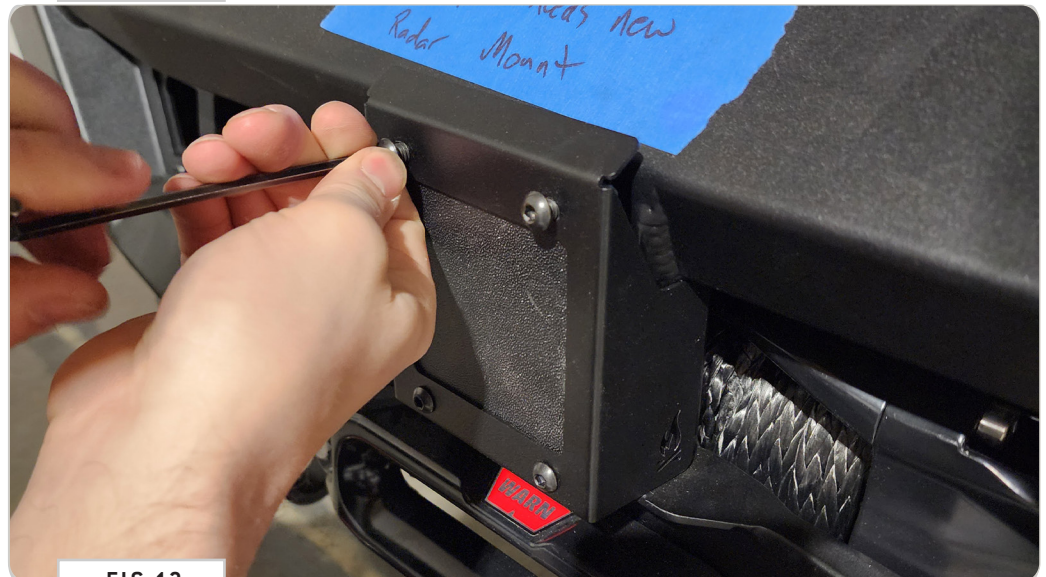

FIG 13

# GET OUT AND EXPLORE!

## + LEAVE US A REVIEW

---

Happy with your new FVC product? We would love to hear (and see) from you! Head to the product page and click "Leave Review." Add a short review and upload a few photos to be showcased on the product page.

## + SHARE YOUR PICS

---

We love seeing how our customers use their FVC products and following along with your adventures. Tag us in your photos with: @flatlinevanco or send them to us via email. We love posting customer pictures in our feed!

## + NEED ANY HELP?

---

If you are having any issues with your product, please reach out, and we will make it right. FVC is a company of van and outdoor enthusiasts that design and use our own products, so we want you to be as stoked on your new parts as we are!



@FLATLINEVANCO