

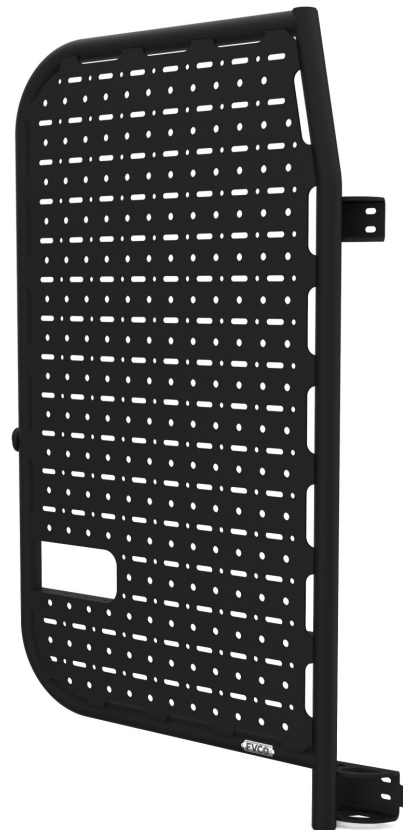

INSTALLATION GUIDE

SPRINTER VAN REAR DOOR PLATFORM

SP1115B



TOOLS REQUIRED (NOT INCLUDED)

- | | |
|---------------------|---------------------------|
| + POWER DRILL | + 9/16" DEEP SOCKET |
| + 3/16" DRILL BIT | + 9/16" SHALLOW SOCKET |
| + 13/32" DRILL BIT | + 7/32" ALLEN WRENCH |
| + RATCHET | + AUTO PANEL REMOVAL TOOL |
| + RATCHET EXTENSION | + MARKER |
| + 9/16" WRENCH | + DEBURR TOOL |
| + 7/16" SOCKET | + RUST PREVENTATIVE PAINT |

INSTALL INFO

TIME TO INSTALL THIS PRODUCT: 1-2 HOURS

Additional help is suggested for a few of the install steps.

BEFORE YOU START

Please inspect the product and packaging upon delivery to ensure there are no issues and that all parts and hardware are accounted for.

Contact us ASAP if anything is missing at:
support@flatlinevanco.com

BEFORE YOU START

All Flatline Van Co products must be properly assembled and secured before attaching to your vehicle. Improper attachment could result in an automobile accident, and could cause serious bodily injury or death to you or to others involved. You are responsible for assembling and securing Flatline Van Co products to your vehicle, checking the mounting points and attachments prior to use, and regularly inspecting the products for wear and or damage. We always recommend you use a professional to install any aftermarket accessories to your vehicle. If you have no mechanical experience and are not thoroughly familiar with the installation procedures, you must have the product installed by a professional installer or other qualified persons. The responsibility is yours and must be taken seriously for everyone's safety.



PACKAGE CONTENTS

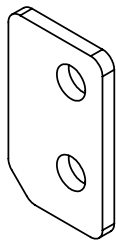

LOWER HINGE BACKING PLATE

QTY: 1

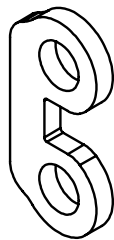

LOWER HINGE BACKING PLATE

QTY: 1

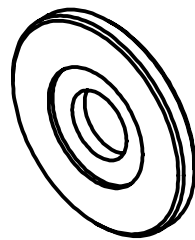

BUSHING CAP

QTY: 1

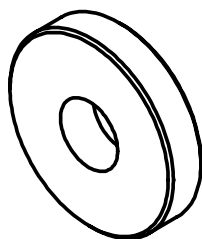

SHORT BUSHING

QTY: 1

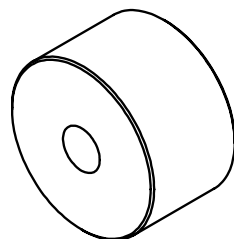

TALL BUSHING

QTY: 1

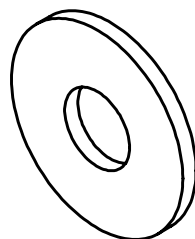

SEALING WASHER

QTY: 1

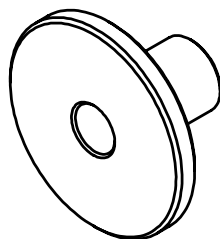

DOOR MOUNTING BOSS

QTY: 1

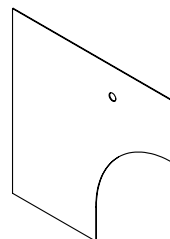

EXTERIOR DRILL TEMPLATE

QTY: 1

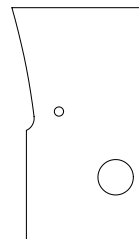

INTERIOR DRILL TEMPLATE

QTY: 1

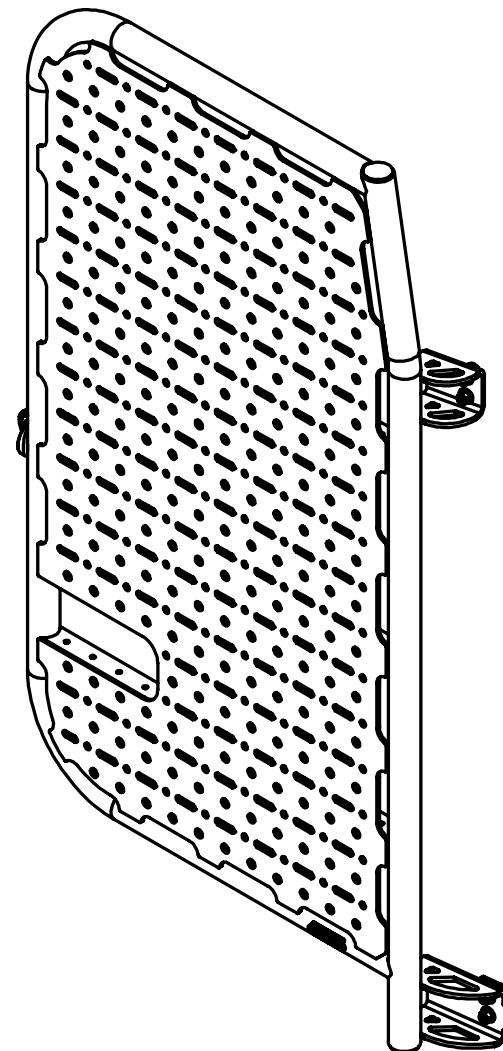

REAR DOOR PLATFORM

QTY: 1

HARDWARE

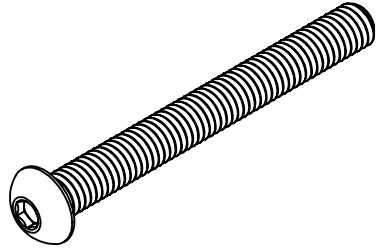

3/8-16 X 3.5 BUTTON HEAD HEX
DRIVE SCREW

QTY: 1

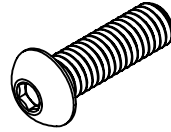

3/8-16 X 1.25 BUTTON HEAD HEX
DRIVE SCREW

QTY: 4



3/8 FLAT WASHER

QTY: 9

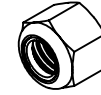

3/8-16 NYLON LOCKNUT

QTY: 5

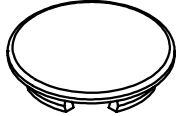

SNAP-IN PANEL PLUG

QTY: 1

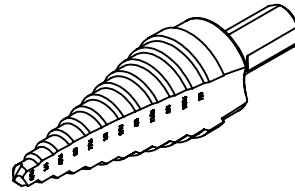

MULTIDIAMETER DRILL BIT

QTY: 1

INSTALL

TOOLS REQUIRED FOR THIS STEP: + AUTO PANEL REMOVAL TOOL

STEP | 01 LAYOUT AND INSTALL PREP

1.1 Door Panel Removal: If applicable, start by removing the lower interior door panel (**FIG 1**) We recommend using plastic panel removal tools (easily found at harbor freight or similar). Be gentle when prying as to not break the factory panel clips. Once you get the first few popped you should be able to pull it the rest of the way with your hands.

NOTE- You may have any number of different door configurations- stock full trim, stock half trim (**FIG 1**), stock panel, upholstered wood, etc. Each require their own removal method.

NOTE - This product is compatible with 2019 and newer vans with 180-degree rear door hinges (**FIG 3**). If your van has 270-degree hinges, you'll need to have them swapped out for 180-degree hinges. You can find them available for purchase [here](#).

NOTE - You may need to migrate the factory rubber bump stop (**FIG 4**) from your original hinges to your new 180-degree hinges.

NOTE- Sometimes the clips will get stuck in the door. All you need to do is pop them out and slide them back in to their location on the trim panel.

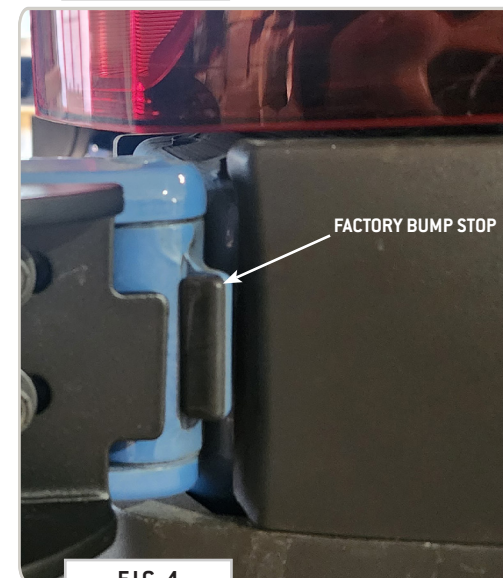
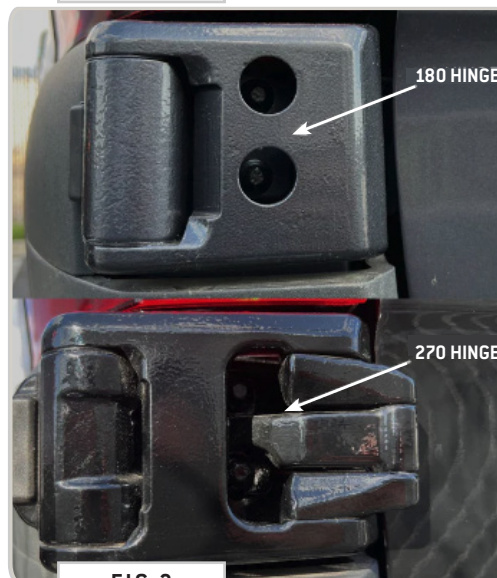
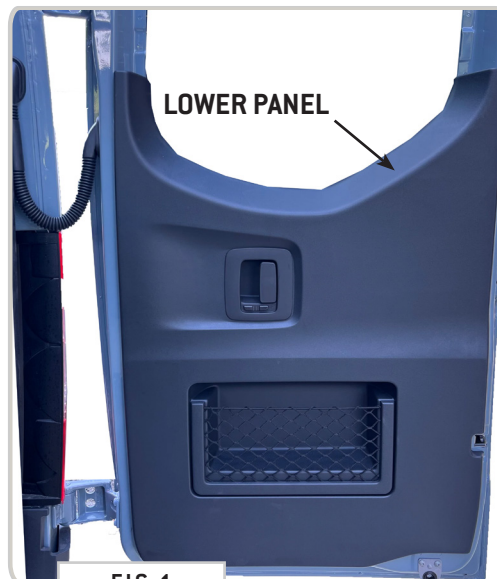

TOOLS REQUIRED FOR THIS STEP:

+	MARKER	+	MULTI-DIAMETER DRILL BIT
+	POWER DRILL	+	DEBURR TOOL
+	3/16" DRILL BIT	+	RUST PREVENTATIVE PAINT

STEP | 02 DRILL THIRD MOUNT

2.1 Exterior Template Marking: Align the provided template with your door panel. Align the left side with the edge of your door and the top with the seam on top as shown in **FIG 5**.

2.2 Pilot Hole: Drill a pilot hole through both layers of metal using a 3/16" Drill Bit (**FIG 6**).

2.3 Drill Out to Final Size: Switch to the included multi-diameter drill bit or "step bit" to drill the hole out to 5/8"

2.4 De-burring the Hole: After drilling, de-burr the hole using a grinding stone, countersink, or a larger drill bit (**FIG 7**).

2.5 Rust Prevention: Clean the area with alcohol, then apply a rust preventive such as Rustoleum paint or any suitable coating (**FIG 8**).



FIG 5



FIG 6

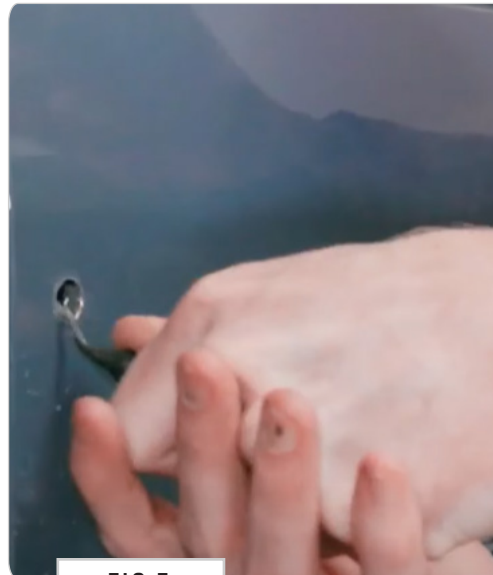

FIG 7



FIG 8

TOOLS REQUIRED FOR THIS STEP:

+	MARKER	+	MULTI-DIAMETER DRILL BIT
+	POWER DRILL	+	DEBURR TOOL
+	3/16" DRILL BIT	+	RUST PREVENTATIVE PAINT

STEP | 02 DRILL THIRD MOUNT

2.6 Interior Template Marking: Align the provided template with the inside of your door panel in the locations shown in **FIG 9-10**. Align the right side with the edge of your door seam (**FIG 9**) and the left with the indentations shown in **FIG 10**.

2.7 Pilot Hole: Drill a pilot hole through both layers of metal using a 3/16" Drill Bit (**FIG 11**).

2.8 Drill Out to Final Size: Switch to the included multi-diameter drill bit or "step bit" to drill the hole out to 7/8" (**FIG 12**)

2.9 De-burring the Hole: After drilling, de-burr the hole using a grinding stone, countersink, or a larger drill bit.

2.10 Rust Prevention: Clean the area with alcohol, then apply a rust preventive such as Rustoleum paint or any suitable coating.



FIG 9

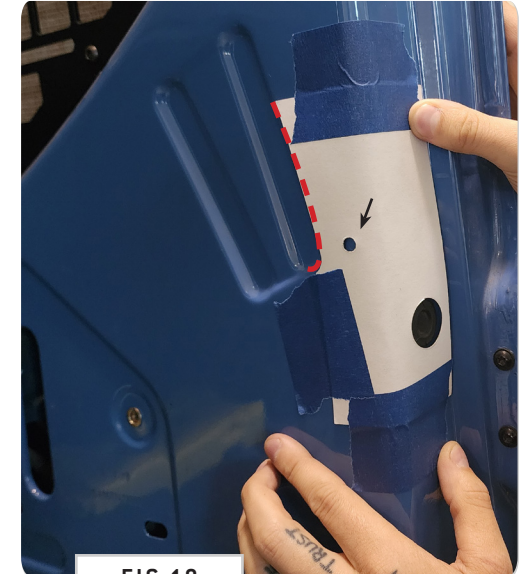

FIG 10



FIG 11

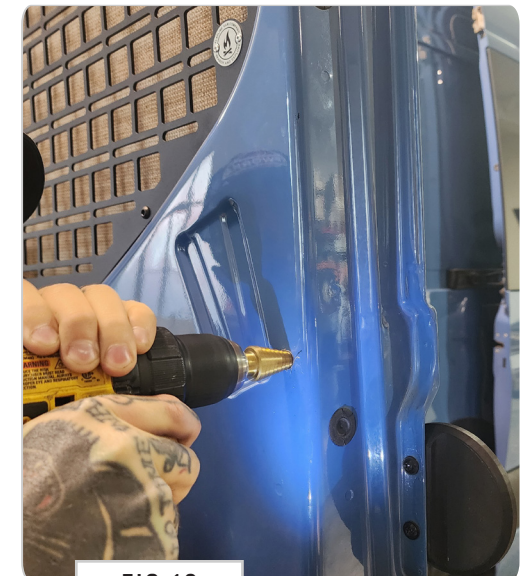

FIG 12

- TOOLS REQUIRED FOR THIS STEP:**
- + RATCHET
 - + RATCHET EXTENSION
 - + 9/16" SHALLOW SOCKET
 - + 9/16" DEEP SOCKET

VAN MOUNTS

3.1 Hinge Backing Plates: Grab both hinge backing plates and (4) 3/8-16 X 1.5 Hex Drive Button Head Screws. Place them into the back of your 180 hinges as shown in FIG 13 and FIG 14.

3.2 Hanging the Rear Door Platform: With someone holding the hardware and backing plates in place, hang the rear door platform on the door. Fasten the 3/8 Flat Washers and 3/8-16 Nylon Insert Locknuts onto the protruding bolts to hold the panel in place, but do not tighten them yet (FIG 15-16).

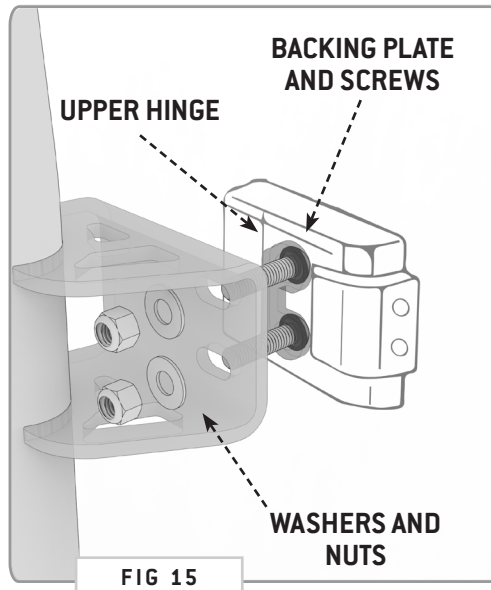
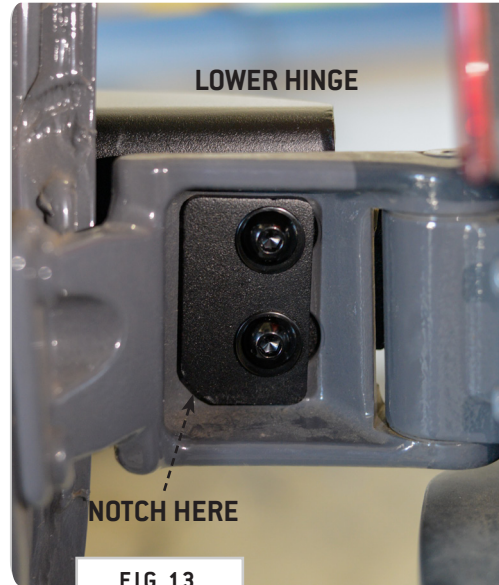

- TOOLS REQUIRED FOR THIS STEP:**
- + RATCHET
 - + RATCHET EXTENSION
 - + 7/16" SOCKET
 - + 9/16" DEEP SOCKET
 - + 9/16" WRENCH (OPTIONAL)
 - + 7/32" ALLEN WRENCH

STEP | 03 VAN MOUNTS

3.3 Third Mount: Put together the **Third Mount Bushing Assembly** shown in **FIG 15** and have someone hold this in place while you start the **3/8 Flat Washer** and **3/8-16 Nylon Insert Locknut** from the inside. Use a **9/16" Shallow Socket** to start, then switch to a **Deep Socket** to tighten, but do not fully tighten the nut yet (**FIG 17-18**).

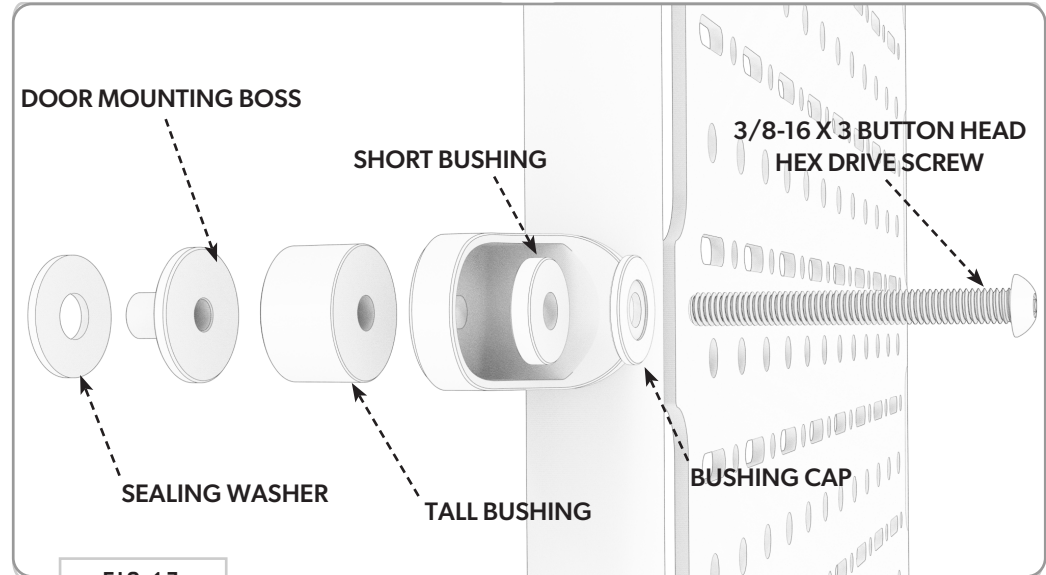

FIG 17

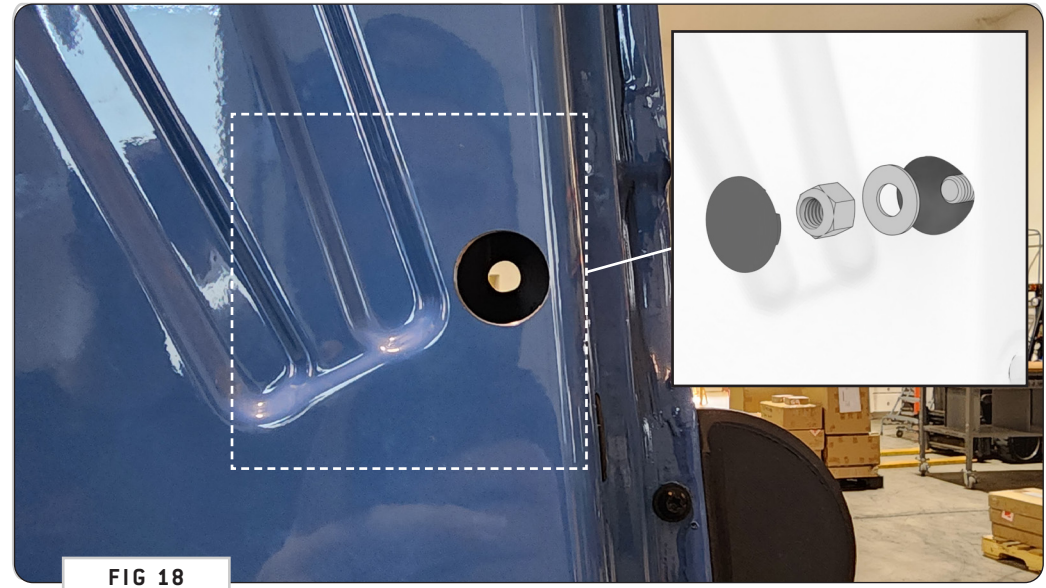

FIG 18

STEP | 04 SECURE THE PLATFORM

4.1 Aligning the Rear Door Platform: The lower hinge mount has a stop built into the bracket. Open your door carefully to approximately 135° (45° away from side of the van) and adjust lower hinge mount into place. Ensure the side of the platform follows the body lines of the van (FIG 19).

4.2 Securing Platform: Once aligned, tighten all bolts/nuts on the Hinge Mounts and Third Mount.

Replace the Lower Interior Panel if applicable and enjoy your new Rear Door Platform!

TOOLS REQUIRED FOR THIS STEP: + RATCHET + 9/16" WRENCH (OPTIONAL)
+ RATCHET EXTENSION + 7/32" ALLEN WRENCH
+ 7/16" SOCKET
+ 9/16" DEEP SOCKET



FIG 19

GET OUT AND EXPLORE!

+ LEAVE US A REVIEW

Happy with your new FVC product? We would love to hear (and see) from you! Head to the product page and click "Leave Review." Add a short review and upload a few photos to be showcased on the product page.

+ SHARE YOUR PICS

We love seeing how our customers use their FVC products and following along with your adventures. Tag us in your photos with: @flatlinevanco or send them to us via email. We love posting customer pictures in our feed!

+ NEED ANY HELP?

If you are having any issues with your product, please reach out, and we will make it right. FVC is a company of van and outdoor enthusiasts that design and use our own products, so we want you to be as stoked on your new parts as we are!



@FLATLINEVANCO