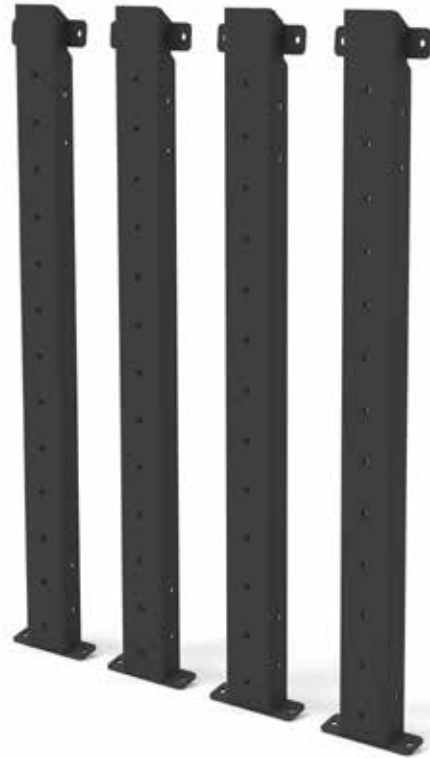




Installation Guide



Promaster DIY Bed Brackets PM0302B

All Flatline Van Co products must be properly assembled and secured before attaching to your vehicle. Improper attachment could result in an automobile accident, and could cause serious bodily injury or death to you or to others involved. You are responsible for assembling and securing Flatline Van Co products to your vehicle, checking the mounting points and attachments prior to use, and regularly inspecting the products for wear and or damage. We always recommend you use a professional to install any aftermarket accessories to your vehicle. If you have no mechanical experience and are not thoroughly familiar with the installation procedures, you must have the product installed by a professional installer or other qualified persons. The responsibility is yours and must be taken seriously for everyone's safety.



thanks.

THANK YOU!

ARE YOU EXCITED ABOUT YOUR NEW BED SYSTEM? HERE ARE A FEW THINGS TO DO BEFORE BEGINNING THE INSTALLATION PROCESS--

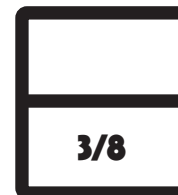
- PLEASE INSPECT THE PRODUCT TO ENSURE THERE WAS NO DAMAGE INCURRED DURING SHIPPING.
- IF THERE IS DAMAGE TO REPORT, PLEASE CONTACT OUR CUSTOMER SERVICE DEPARTMENT AS SOON AS POSSIBLE.
- NEXT, USING THE "PACKAGE CONTENTS" PAGE, CHECK INVENTORY AND FAMILIARIZE YOURSELF WITH THE PARTS AND HARDWARE.
- GATHER ALL TOOLS REQUIRED FOR INSTALL.
 - TAPE MEASURE
 - IMPACT DRIVER
 - 3/8 DRIVER BIT

ESTIMATED INSTALL TIME- 1 HR

SEE THE INSTALL VIDEO HERE-

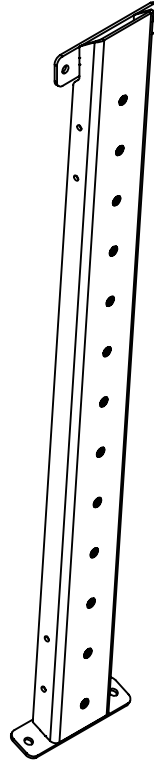
<https://youtu.be/TKOfP2MveEI>

TOOLS



3/8 SOCKET

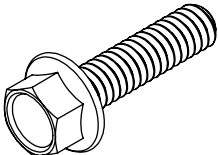
PACKAGE CONTENTS



BED BRACKET

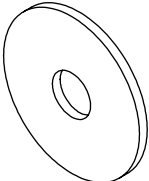
QTY - 4

HARDWARE



1/4-20 X 1 FLANGED HEX HEAD
SCREW

QTY - 8



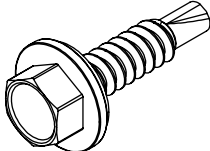
1/4 SCREW X 1 O.D. OVERSIZED
FLAT WASHER

QTY - 8



1/4 SCREW X 0.09375 SPACER

QTY - 8



1/4 SELF DRILLING SCREW

QTY - 16

LET'S GET STARTED!

1. FIRST STEP IS TO MEASURE AND MARK THE LOCATIONS FOR OUR BRACKETS TO GO INSIDE THE VAN. YOU WANT TO MEASURE FROM THE REAR EDGE OF THE SHEET METAL ON THE WALL AS SHOWN IN **FIGURE 1**. PLACE A MARK ON THE "WINDOW LEDGE" AT **4.5"** AND **54.5"**

NOTE- THE MOST IMPORTANT MEASUREMENT WILL BE YOUR CENTERLINE MEASUREMENT OF THE BRACKETS ONCE INSTALLED. THEY SHOULD MEASURE 50" CENTER TO CENTER.

FIGURE 1



FIGURE 2



REAR OF VAN

2. NEXT, GRAB YOUR FIRST BRACKET AND SET IT ON THE LEDGE. YOU WANT TO ENSURE THE BRACKET FACE RESTS FLUSH WITH THE WALL STRUCTURE. LINE IT UP WITH YOUR FIRST MARK AT **4.5"** AS SHOWN IN **FIGURE 4** AND DRIVE IN THE FIRST **1/4 SELF DRILLING SCREW**.

NOTE- FOR SOME INSTALLATIONS IT IS EASIER TO MARK YOUR HOLE LOCATIONS AND DRILL AN 1/8" PILOT HOLE BEFORE DRIVING THE SELF DRILLING SCREWS.

FIGURE 3



FIGURE 4



**ALIGN BACK SIDE OF BRACKET
CHANNEL WITH YOUR MARK**

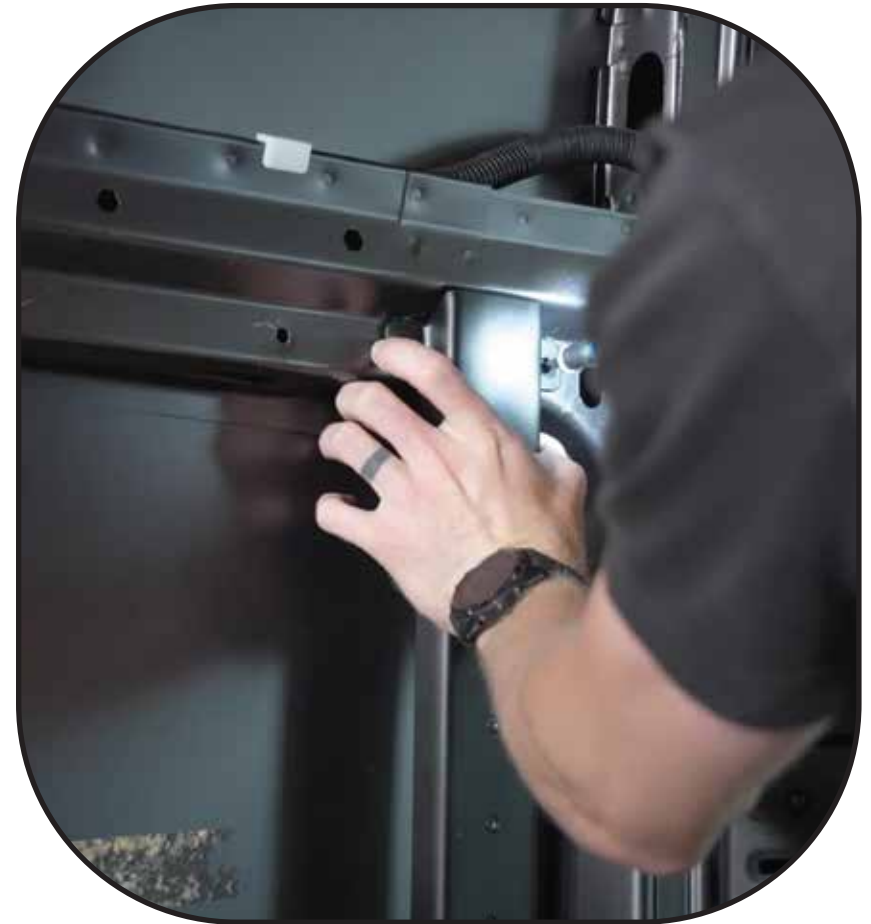
3. THE BRACKET SHOULD STAND STRAIGHT ON IT'S OWN DUE TO IT'S DESIGN, BUT VERIFY THAT IT IS STANDING STRAIGHT AND DRIVE THE REST OF THE 1/4 SELF DRILLING SCREWS IN. REPEAT STEPS FOR THE REMAINING 3 BRACKETS, REMEMBERING THAT IT IS THE BACK SIDE (CLOSEST TO REAR OF VAN) THAT IS ALIGNED WITH THE MARKS YOU MADE .

NOTE- ENSURE THAT ALL OF THE BRACKETS ARE IN SQUARE BY VERIFYING THE CENTERLINE MEASUREMENT OF 50" TOP AND BOTTOM. CROSS SQUARING IS A GOOD IDEA AS WELL.

FIGURE 5

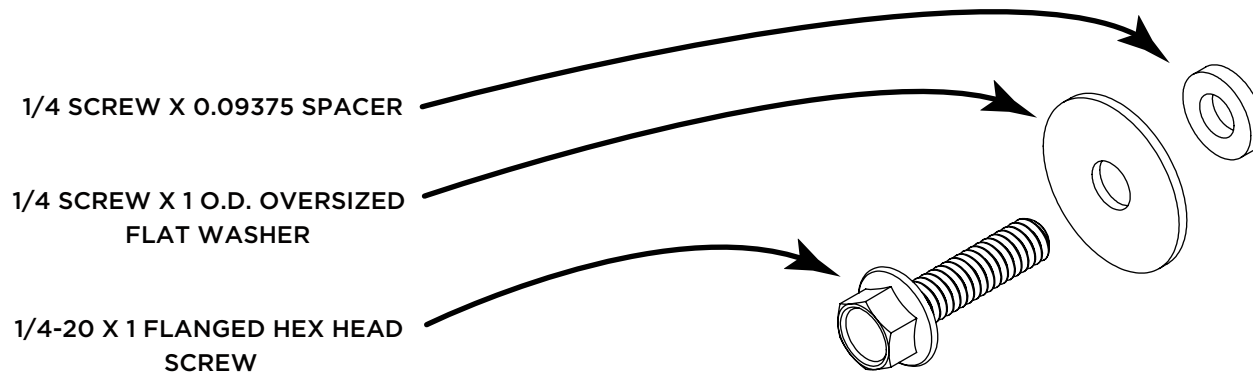


FIGURE 4



4. IF YOU ARE INSTALLING YOUR BED SYSTEM WITHOUT USING L-TRACK, THE DIAGRAM BELOW SHOWS THE ASSEMBLY ORDER OF THE FASTENERS TO ATTACH THE BED RAIL TO THE DIY BED BRACKETS. THE INCLUDED SPACER IS TO ASSIST IN PROPER ALIGNMENT AND SAVE THE THREADS OF THE SCREWS FROM DAMAGE.

NOTE- IF YOU DO NOT INTEND TO MOVE YOUR BED UP AND DOWN OFTEN, WE SUGGEST APPLYING BLUE LOCTITE TO THE THREADS OF THE SCREWS TO PREVENT THEM FROM LOOSENING OVER TIME.



5. THE HOLE SPACING ON THE BED BRACKETS IS SPACED TO ACCOMMODATE 2" ADJUSTMENTS IN HEIGHT. THIS SPACING ALSO ALLOWS THE MOUNTING OF L-TRACK. HARDWARE IS NOT PROVIDED, AND L-TRACK MUST BE PURCHASED SEPARATELY. WE SUGGEST USING A 1/4-20 X 1" FLATHEAD SCREW TO SECURE L-TRACK TO OUR BED BRACKETS.

NOTE- ENSURE THAT THE L-TRACK PURCHASED HAS THE STANDARD 4" ON CENTER MOUNT HOLE SPACING TO FIT THE BED BRACKETS.

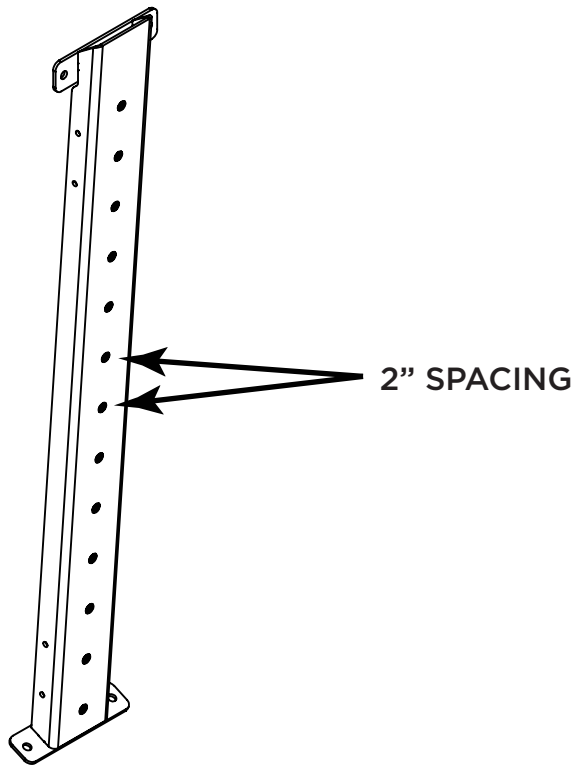


FIGURE 6



6. PLEASE SEE OUR GUIDE FOR THE PROMASTER BED SYSTEM TO COMPLETE THE INSTALLATION! THERE WILL BE MORE DETAILS REGARDING THE BED INSTALL AND ADJUSTMENT. WE ALSO HAVE AN INSTALLATION VIDEO AVAILABLE ON OUR WEBSITE.



GET OUT AND EXPLORE!

LEAVE US A REVIEW

Happy with your new FVC product? We would love to hear (and see) from you! Head to the product page and click "Leave Review." Add a short review and upload a few photos to be showcased on the product page.

SHARE YOUR PHOTOS WITH US

We love seeing how our customers use their FVC products and following along with your adventures. Tag us in your photos with @flatlinevanco or send them to us via email. We love posting customer pictures in our feed!

CUSTOMER SUPPORT

If you are having any issues with your product, please reach out, and we will make it right. FVC is a company of van and outdoor enthusiasts that design and use our own products, so we want you to be as stoked on your new parts as we are!



@flatlinevanco



facebook.com/flatlinevanco



youtube.com/c/flatlinevanco



support@flatlinevanco.com



thanks!